

OCTA NORM

フレーム各種

COMBINE
WITH A SYSTEM

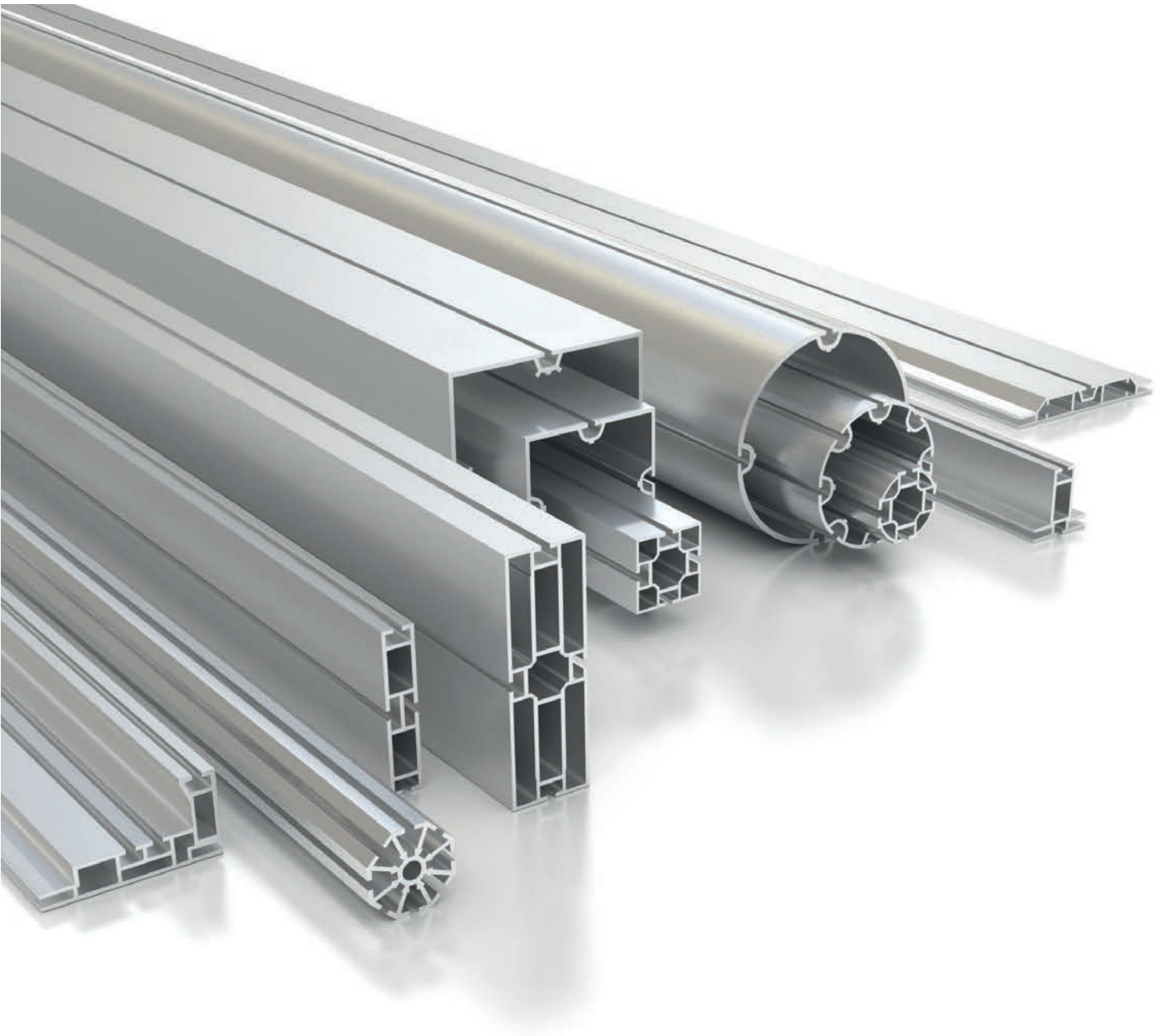

- このカタログはフレームの形状別に分類されています
- 長物は5000 mm からご希望のサイズにカットして販売いたします
- 色は基本がシルバーマット、ポリッシュ、特注で粉体焼付などに対応いたします
- 掲載されている商品は、受注後にご希望のサイズに加工し納品されます
- * 印のついた製品は、特注品・海外取寄せ製品のため、別途お問い合わせください
- * 印のついた製品は、在庫がなくなり次第販売終了となります

もくじ

アルミニウム フレーム	5
ポール・ビーム	7
四角プロファイル	9
長方形プロファイル	15
八角形プロファイル	27
三角プロファイル	29
コーナープロファイル	31
ヒンジプロファイル	33
丸型プロファイル	35
手すりパーツ	37
ファブリック用フレーム	39
テンションファブリックプロファイル	41
ファブリックバナー用プロファイル	51
特殊プロファイル	53
カバープロファイル	55
ウォールパネルリテーナー	57
スペーサー	59
その他	61
プラスチック製品	67
インデックス	71



ALU MINI UM

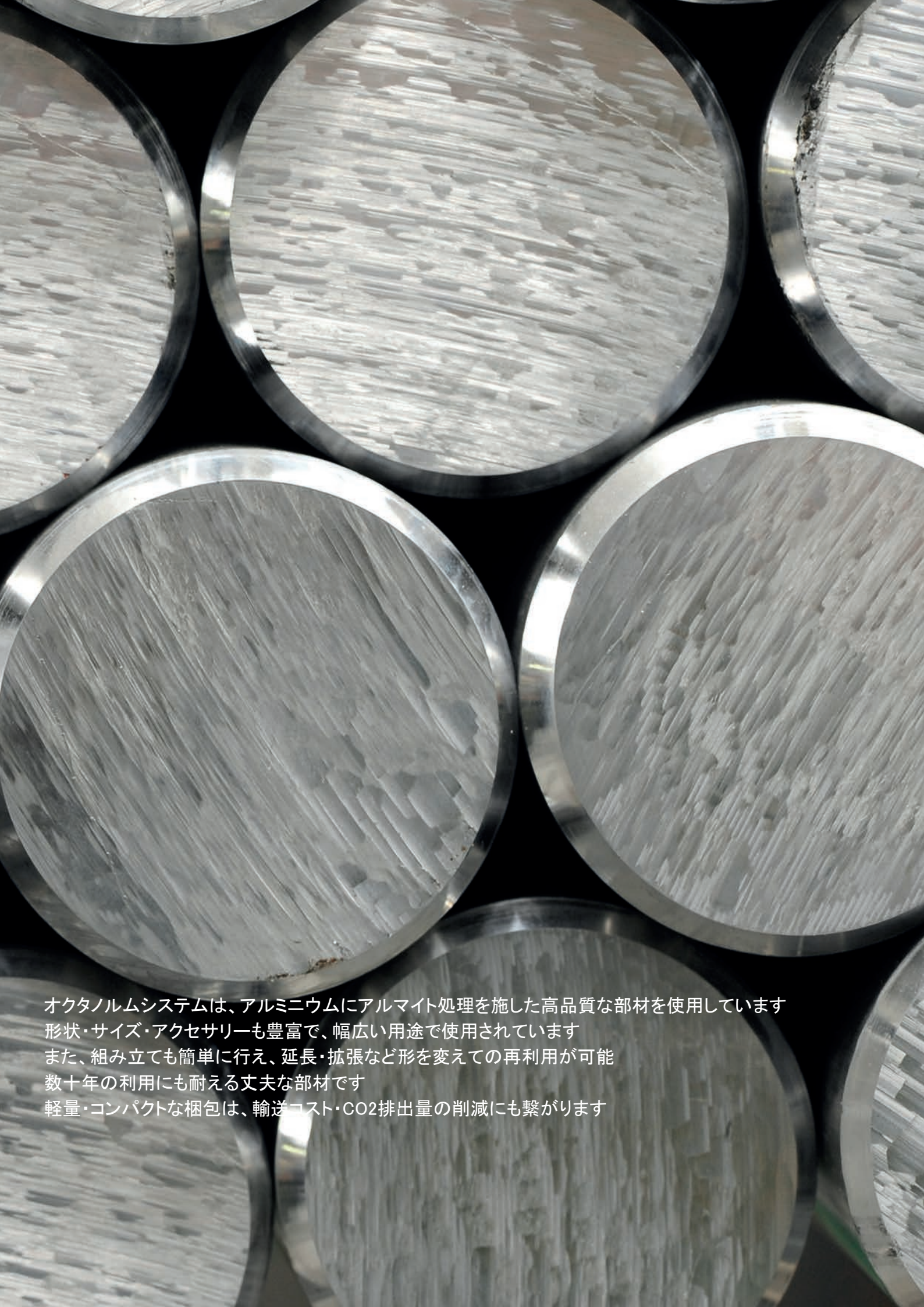

オクタノルムシステムは、アルミニウムにアルマイト処理を施した高品質な部材を使用しています
形状・サイズ・アクセサリも豊富で、幅広い用途で使用されています
また、組み立ても簡単に行え、延長・拡張など形を変えての再利用が可能
数十年の利用にも耐える丈夫な部材です
軽量・コンパクトな梱包は、輸送コスト・CO2排出量の削減にも繋がります

**UP
RIGHTS
AND
BEAMS**



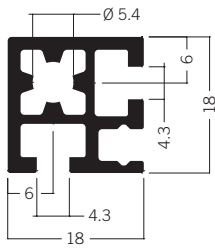

M 1618* Square extrusion 18 mm
1.99 kg

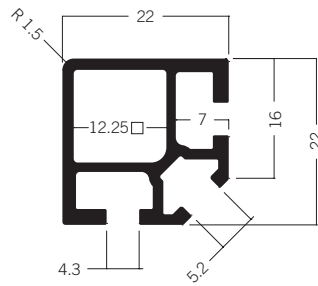

M 1625** Square extrusion 22 mm
2.15 kg

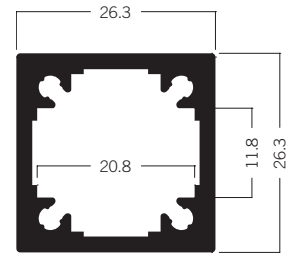

M 1400* Square extrusion 26.3 mm
2.17 kg

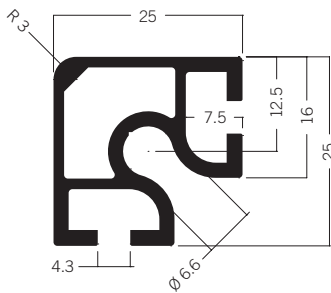

V 2000* Square extrusion 25 mm
2.89 kg

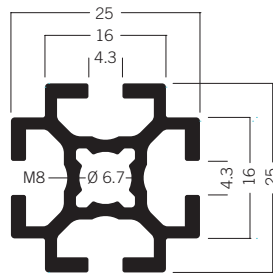

S 10* Square extrusion 25 mm
3.08 kg

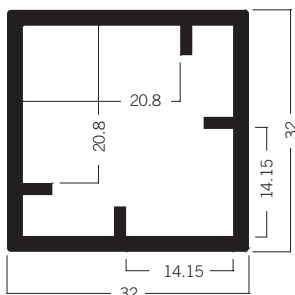

S 1123* Square extrusion 32 mm
3.77 kg

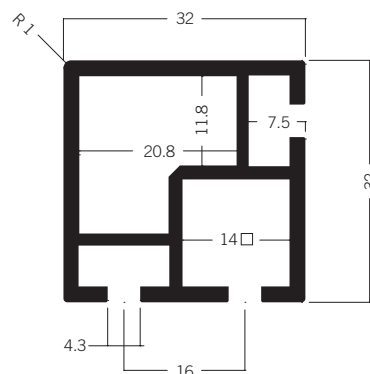

S 1125* Square extrusion 32 mm
4.03 kg

ポール・ビーム

Square Extrusions

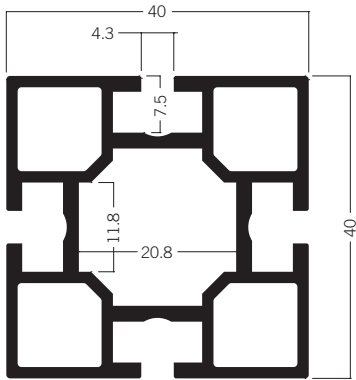

M 1000 Square extrusion 40 mm
5.78 kg

M 1001* Square extrusion 40 mm
6.97 kg

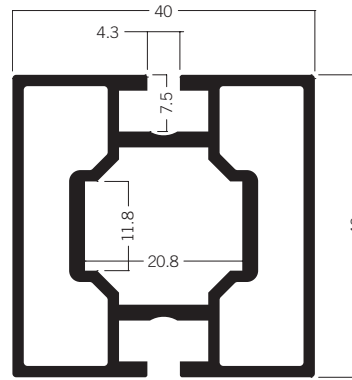

M 1002 Square extrusion 40 mm
5.55 kg

M 1003* Square extrusion 40 mm
6.92 kg

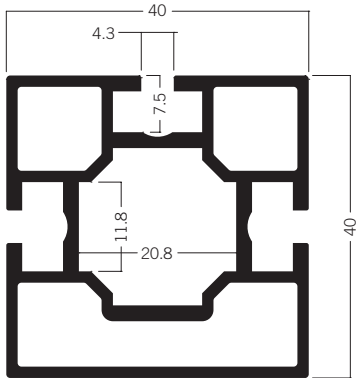

M 1005 Square extrusion 40 mm
6.66 kg

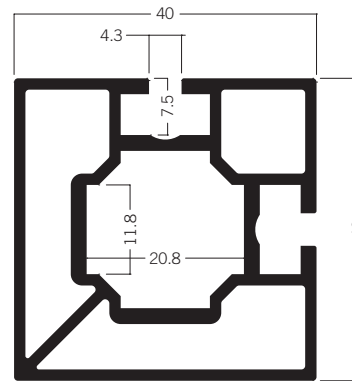

M 1007 Square extrusion 40 mm
7.17 kg

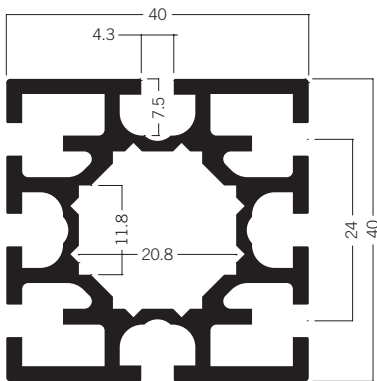

S 209 Square extrusion 40 mm
8.05 kg

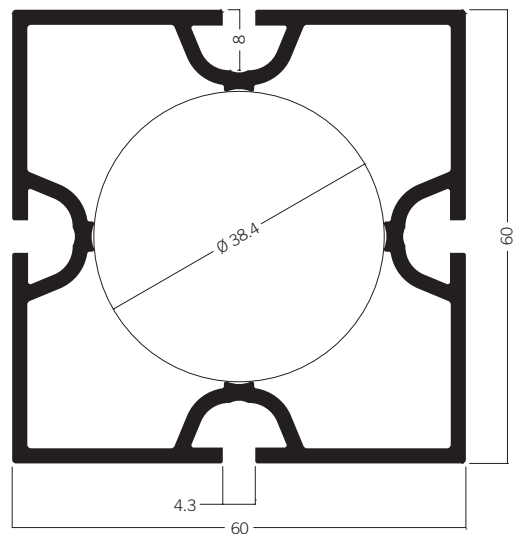

M 1010* Square extrusion 60 mm
8.13 kg

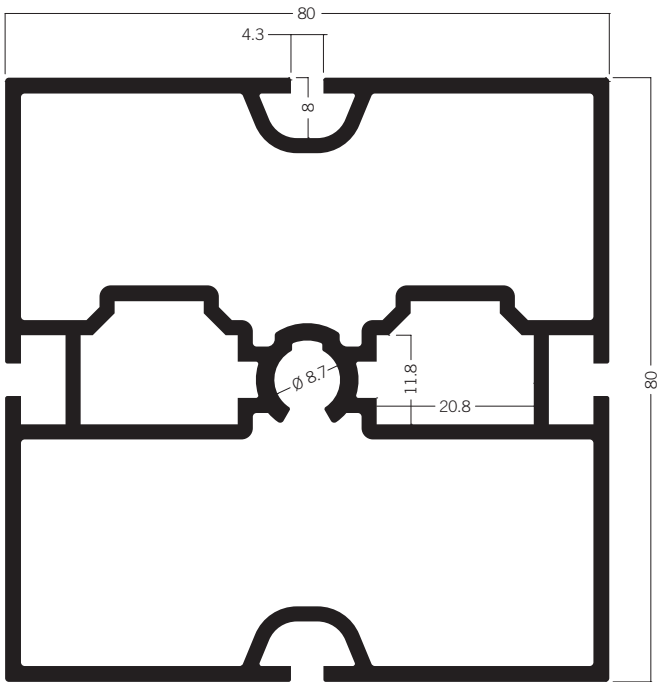

M 1018 Square extrusion 80 mm
14.91 kg

M 1019* Square extrusion 80 mm
17.80 kg

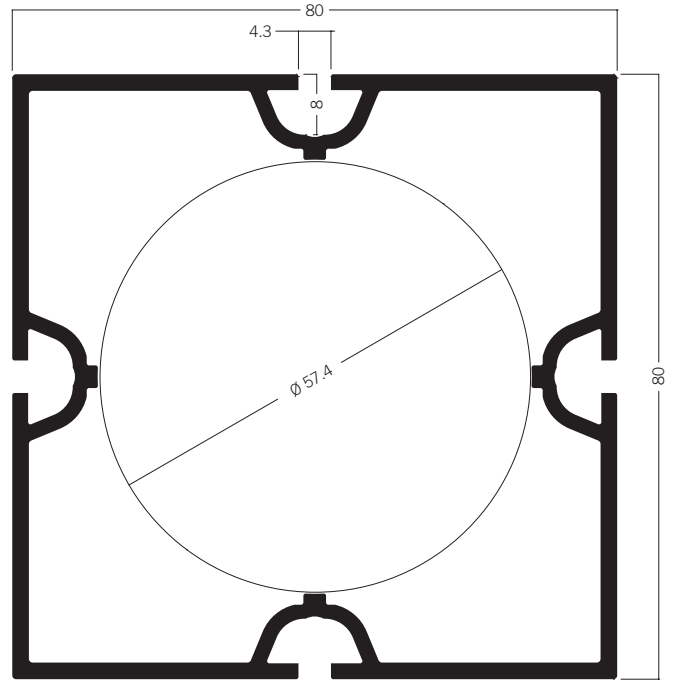

M 1020 Square extrusion 80 mm
11.51 kg

M 1021* Square extrusion 80mm
12.89 kg

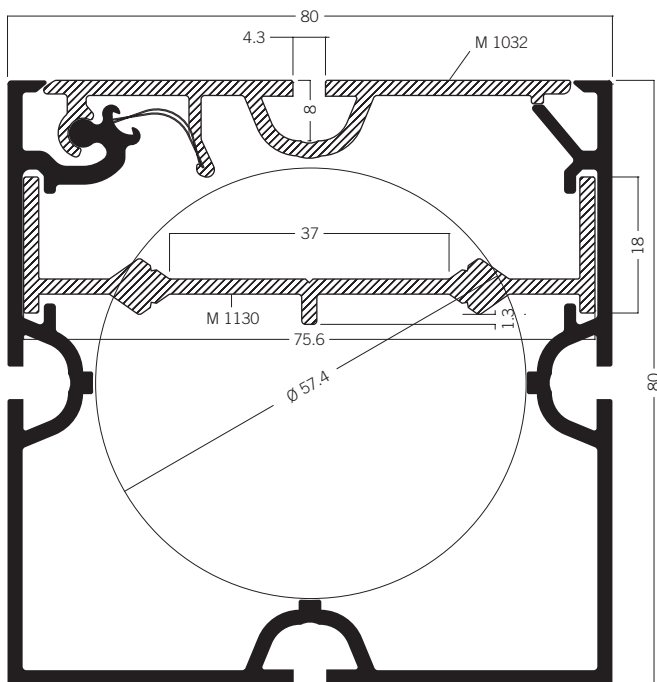

M 1022** Square extrusion 80mm
15.66 kg

M 1023* Square extrusion 80 mm
17.24 kg

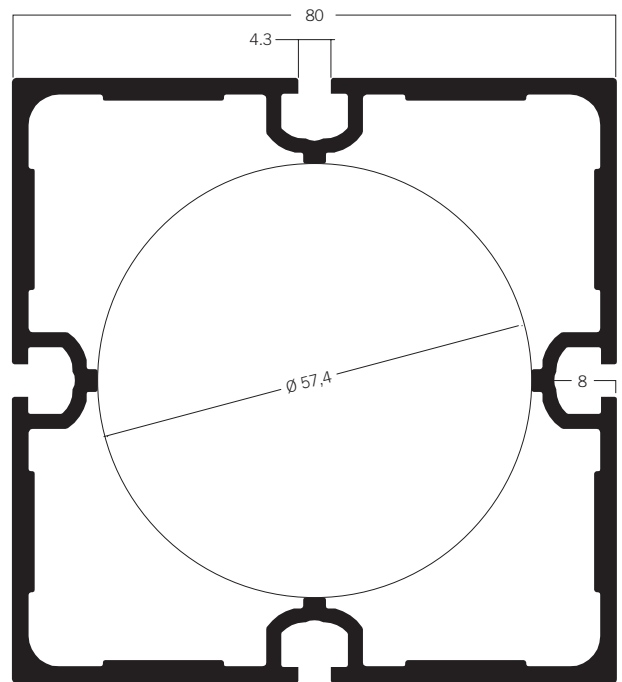

U 1020 * Square extrusion 80 mm
15.50 kg

ポール・ビーム

Square Extrusions

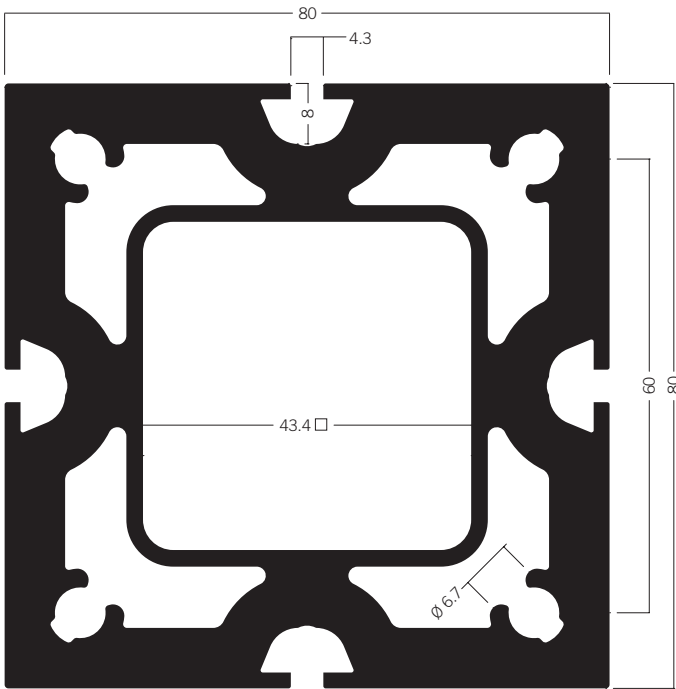

DFS 84 Upright extrusion 80 mm
38.95 kg

DFS 84/6000* Upright extrusion 80 mm
46.28 kg

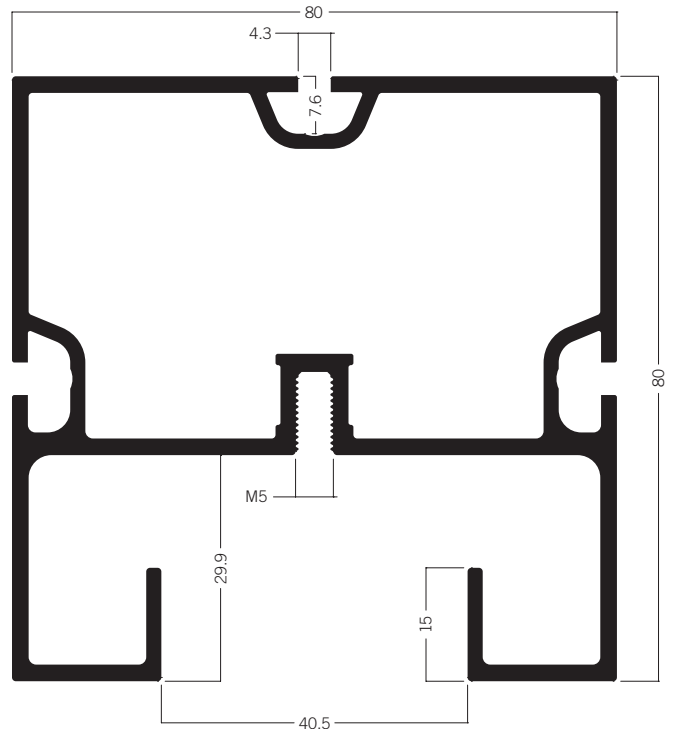

M 1059* Light track mounting extrusion 80 mm
15.92 kg

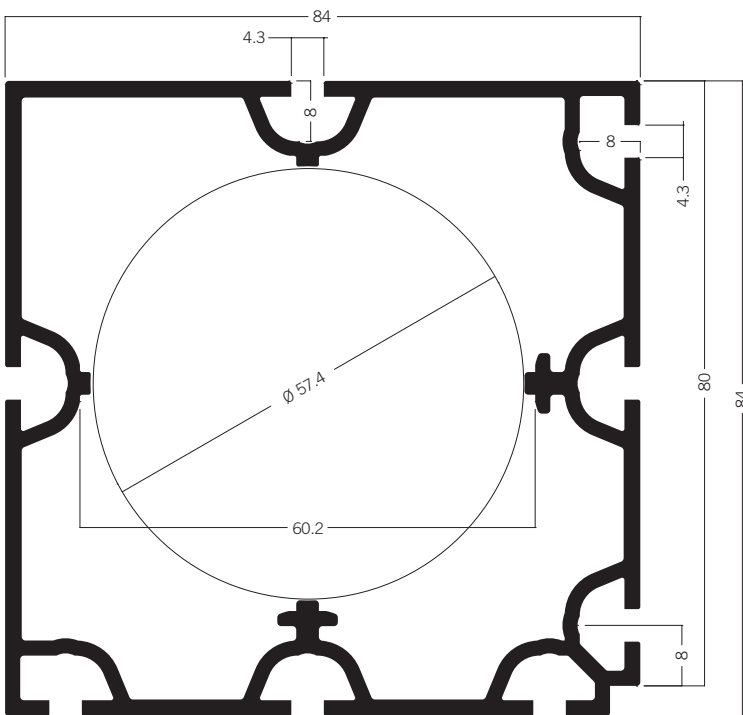

M 1017* Square extrusion 84 mm
12.05 kg

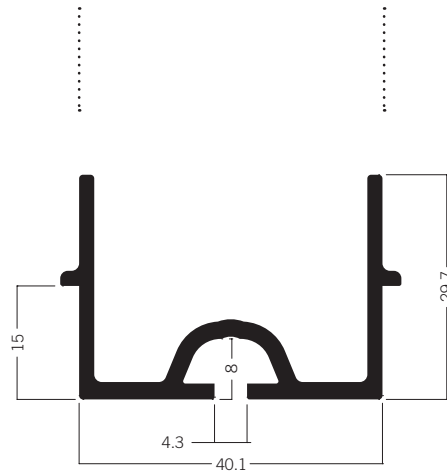

M 1155* Cover extrusion for M 1059
3.46 kg

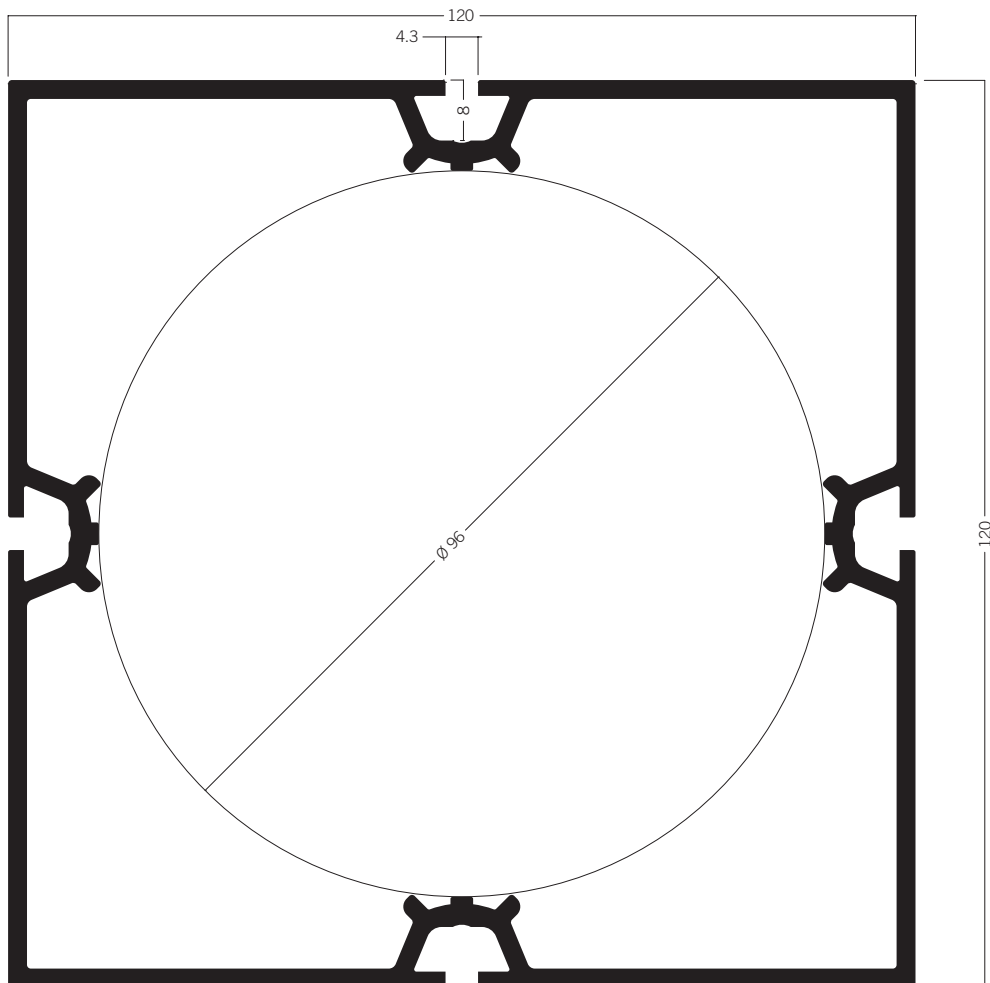

M 225 Square extrusion 120 mm
19.81 kg

M 226 Square extrusion 120 mm
22.71 kg

ポール・ビーム

Square Extrusions

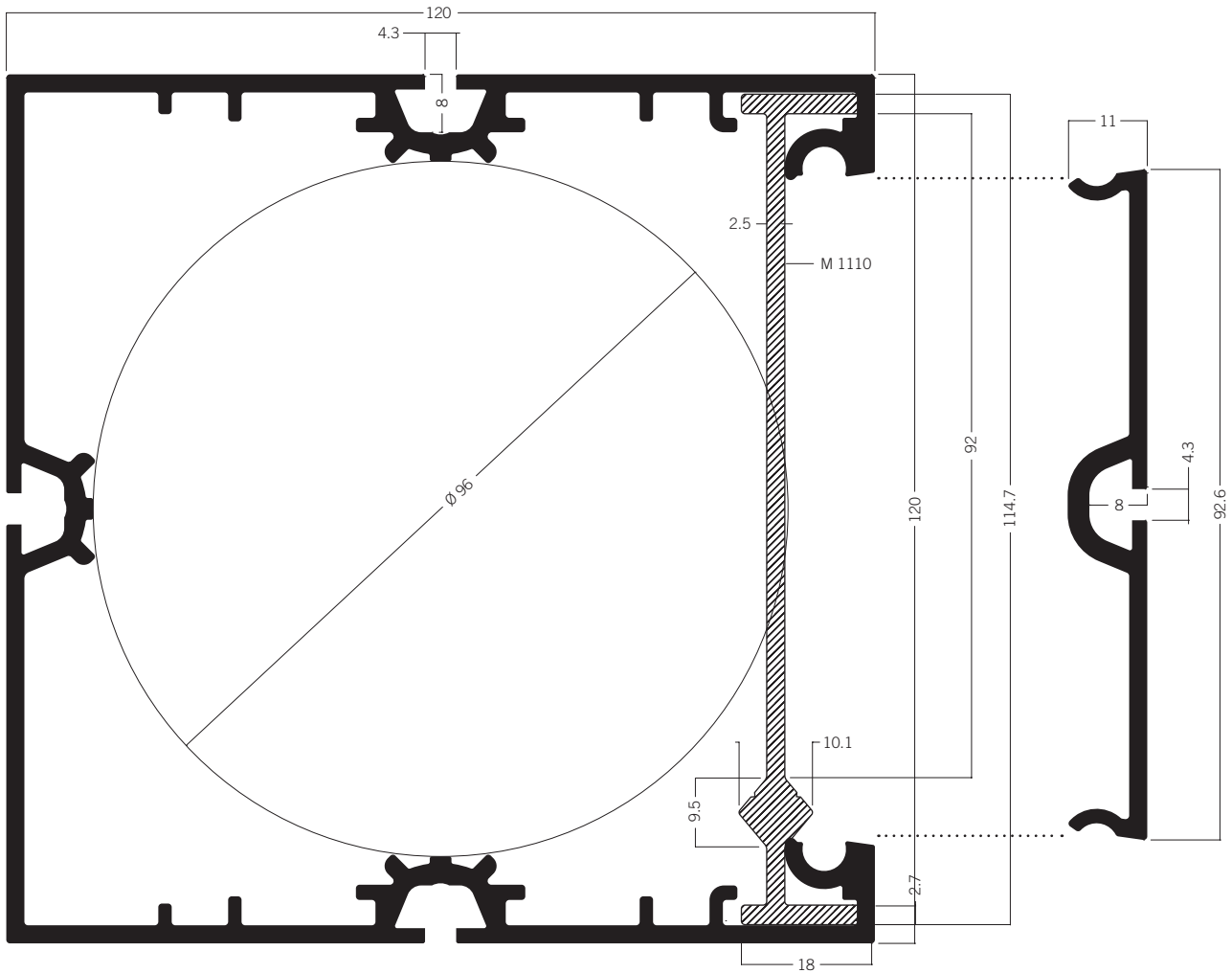

M 1041* Square extrusion open 120 mm
21.85 kg

M 1046* Cover extrusion
5.30 kg

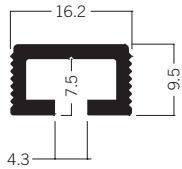

W 416* Insert extrusion 16 mm
1.05 kg

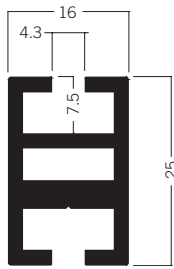

M 1602* Beam extrusion 25 mm
2.72 kg

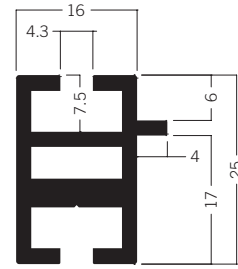

M 1603** Beam extrusion 25 mm
2.74 kg

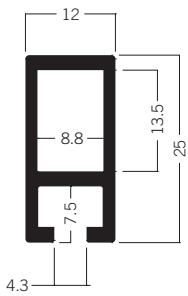

Z 305 Beam extrusion 25 mm
1.72 kg

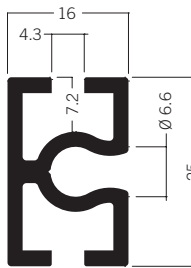

V 2040* Upright extrusion 25 mm
2.41 kg

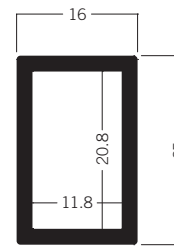

Z 300 Beam extrusion 25 mm
2.05 kg

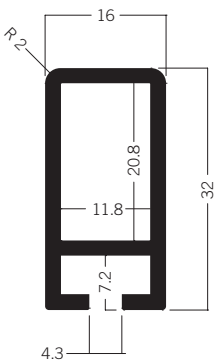

Z 303 Beam extrusion 32 mm
2.70 kg

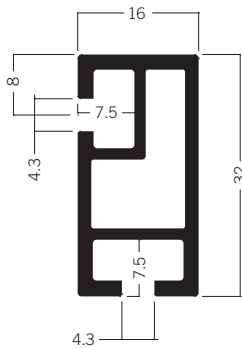

Z 307* Beam extrusion 32 mm
2.53 kg

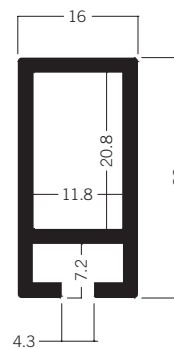

Z 308 Beam extrusion 32 mm
2.68 kg

ポール・ビーム

Rectangular Extrusions

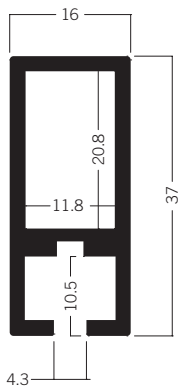

Z 310 Beam extrusion 37 mm
2.96 kg

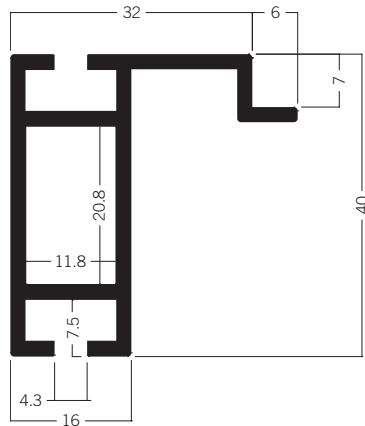

Z 4100* Beam extrusion 40 mm
4.14 kg

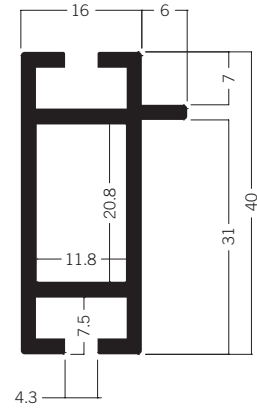

Z 4300* Beam extrusion 40 mm
3.54 kg

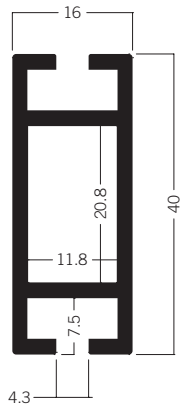

Z 4400 Beam extrusion 40 mm
3.20 kg

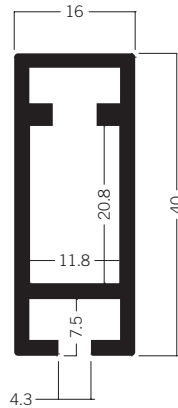

Z 4401* Beam extrusion 40 mm
3.38 kg

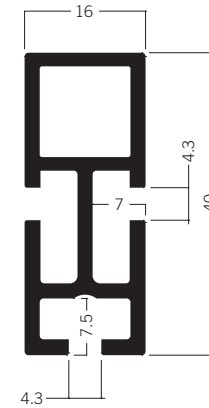

Z 4700* Rectangular extrusion 40 mm
3.49 kg



Z 100* Beam extrusion 43 mm
3.14 kg

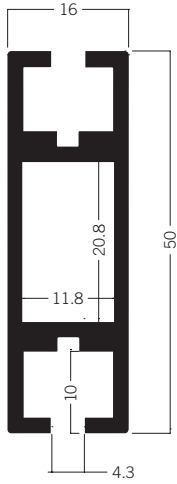

Z 400 Beam extrusion 50 mm
4.39 kg

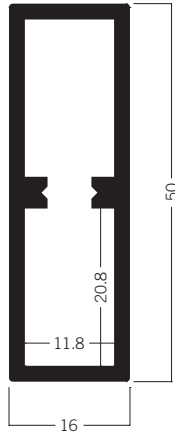

Z 402 Beam extrusion 50 mm
3.76 kg

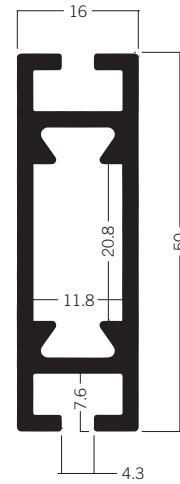

Z 408* Beam extrusion 50 mm
4.39 kg

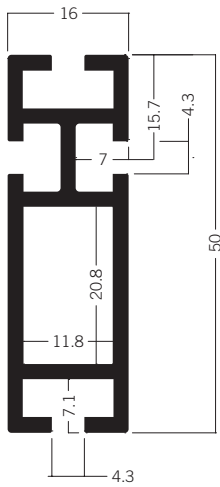

Z 460 Beam extrusion 50 mm
3.96 kg

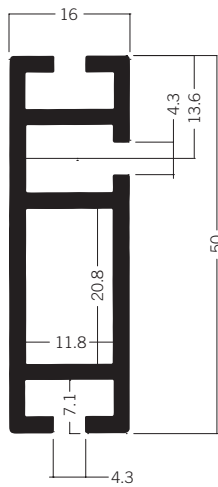

Z 464* Beam extrusion 50 mm
4.11 kg

ポール・ビーム

Rectangular Extrusions

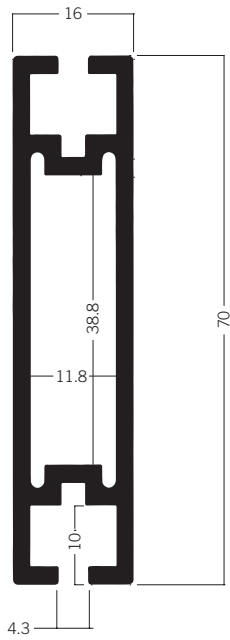

Z 110 Beam extrusion 70 mm
5.42 kg

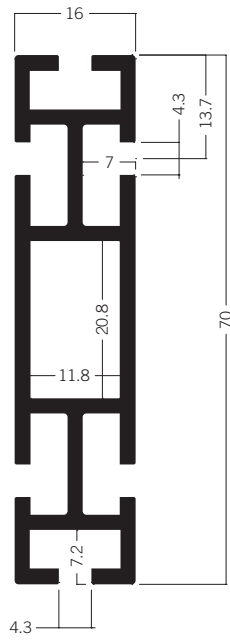

Z 160* Beam extrusion 70 mm
5.43 kg

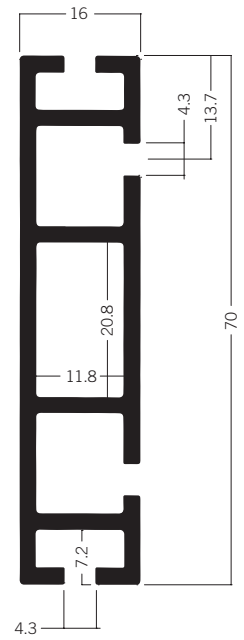

Z 164* Beam extrusion 70 mm
5.85 kg

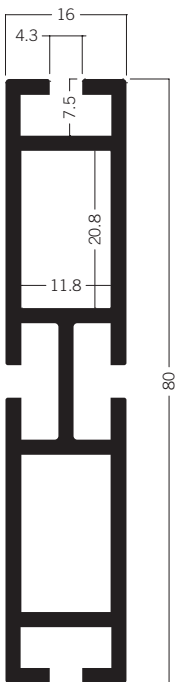

M 1320 Beam extrusion 80 mm
6.45 kg

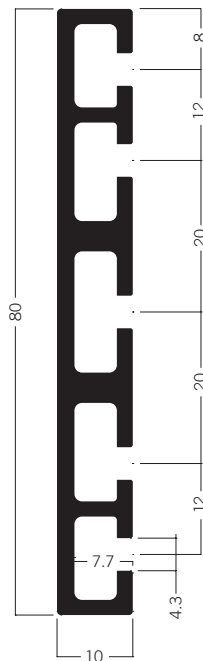

M 1063* Connecting extrusion 80 mm
5.46 kg

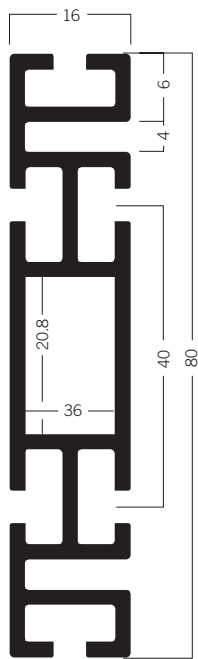

U 1066* Fabric suspension-spacing extrusion
80 x 16 mm
8.25 kg

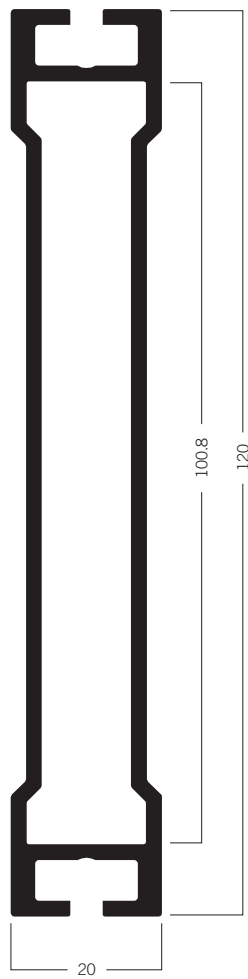

U 1030** Beam extrusion
120 mm
9.51 kg

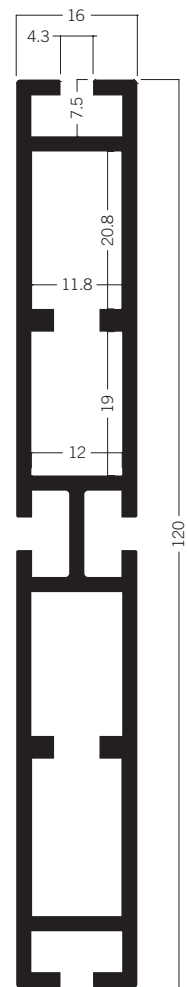

M 1340* Beam extrusion
120 mm
9.00 kg

ポール・ビーム

Rectangular Extrusions

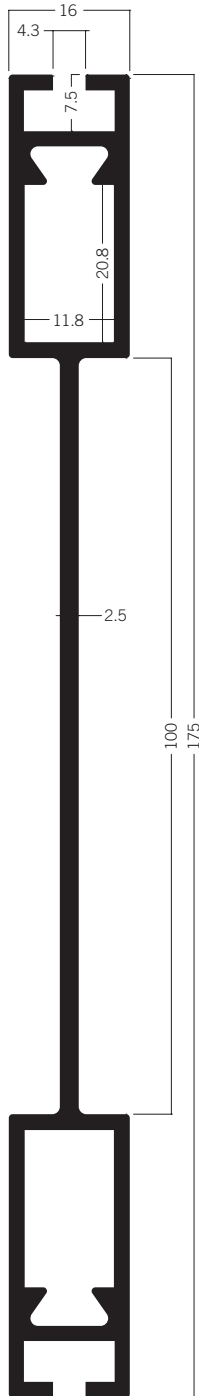

Z 508* Beam extrusion
175 mm
9.95 kg

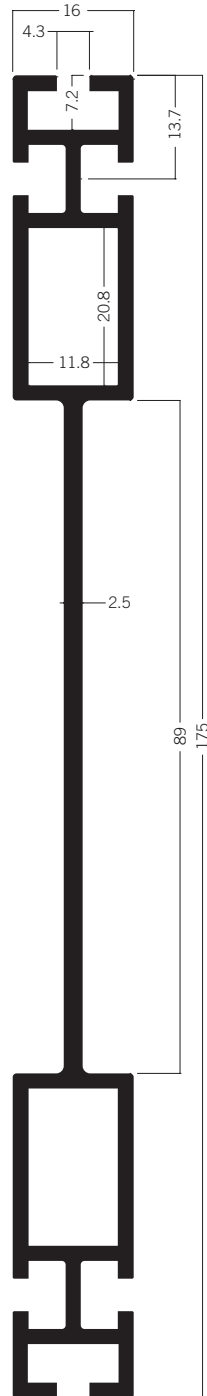

Z 560* Beam extrusion
175 mm
10.32 kg

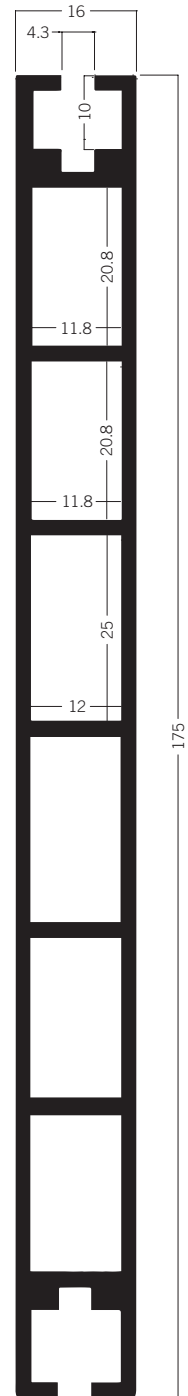

Z 600* Beam extrusion
175 mm
13.53 kg

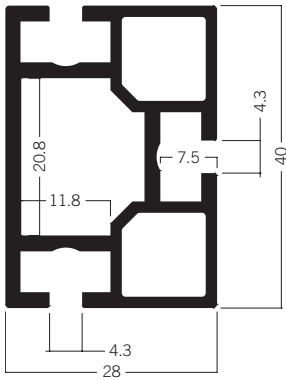

M 1069 * Rectangular extrusion 40 mm
5.71 kg

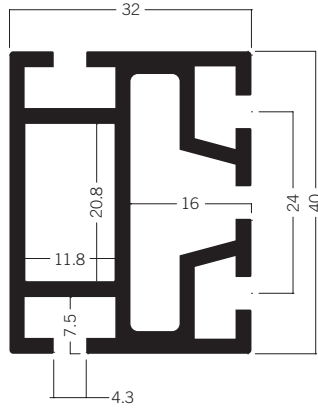

Z 2100 * Beam extrusion 40 mm
5.99 kg

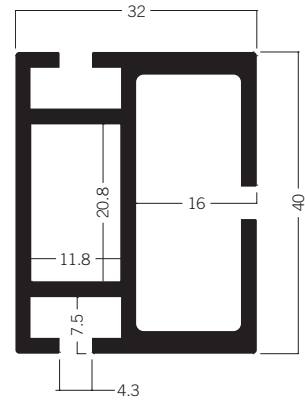

Z 2105 * Beam extrusion 40 mm
5.56 kg

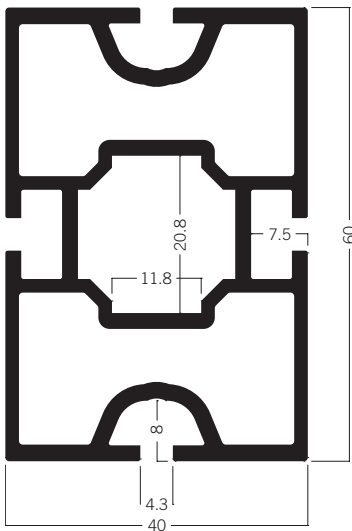

M 1081 * Rectangular extrusion 60 mm
8.94 kg

M 1082 * Rectangular extrusion 60 mm
10.73 kg

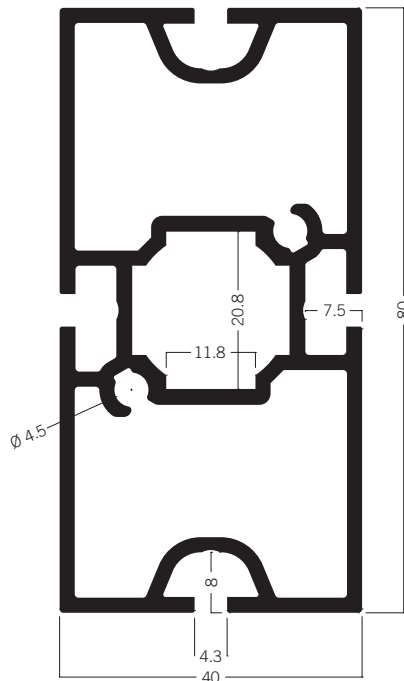

M 1025 Rectangular extrusion 80 mm
10.22 kg

M 1026 * Rectangular extrusion 80 mm
12.70 kg

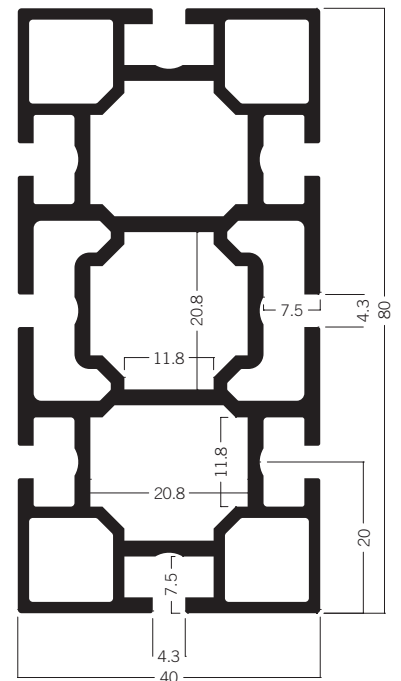

M 1092 * Rectangular extrusion 80 mm
14.60 kg

ポール・ビーム

Rectangular Extrusions

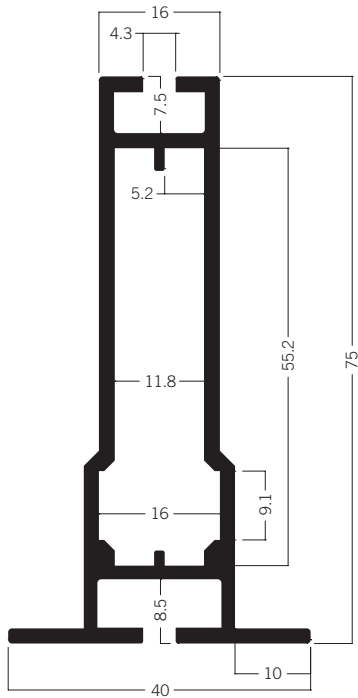

W 901* Frame extrusion 40 mm Panel
7.51 kg

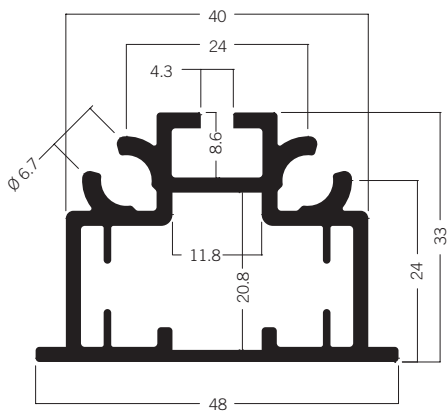

S 1610** Frame extrusion 48 mm
6.48 kg

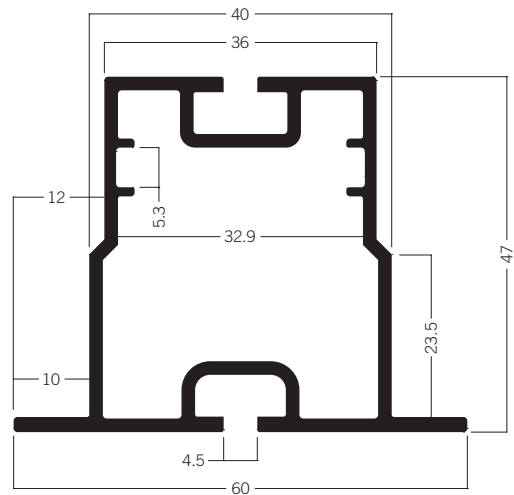

W 825* Frame extrusion 60 mm Panel (USA)
7.20 kg

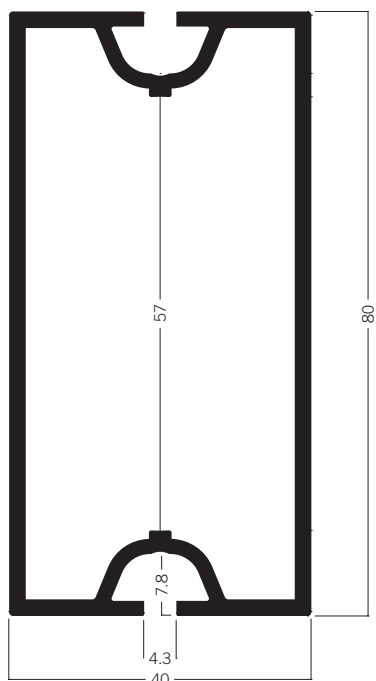

M 1043* Rectangular extrusion 80 mm

5.61 kg

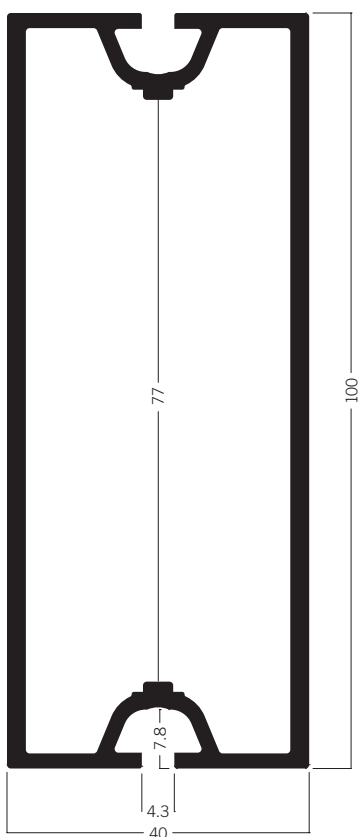

M 1029* Rectangular extrusion 100 mm
11.88 kg

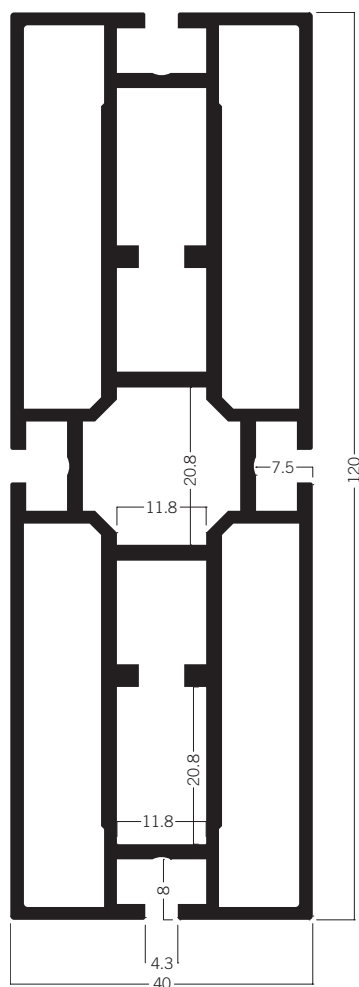

M 1031 Rectangular extrusion 120 mm
18.07 kg

ポール・ビーム

Rectangular Extrusions

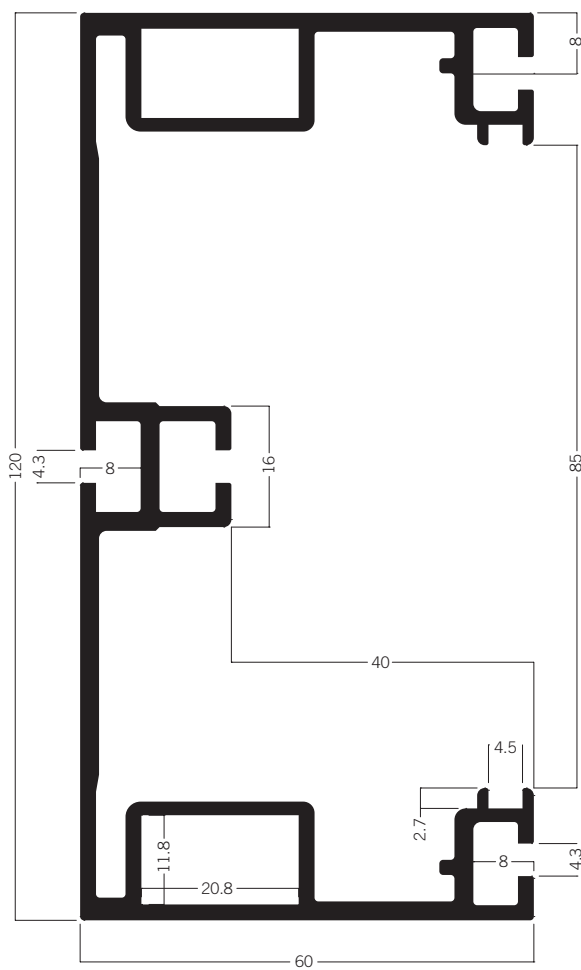

M 1060** Rectangular extrusion open 120 × 60 mm
5.61 kg

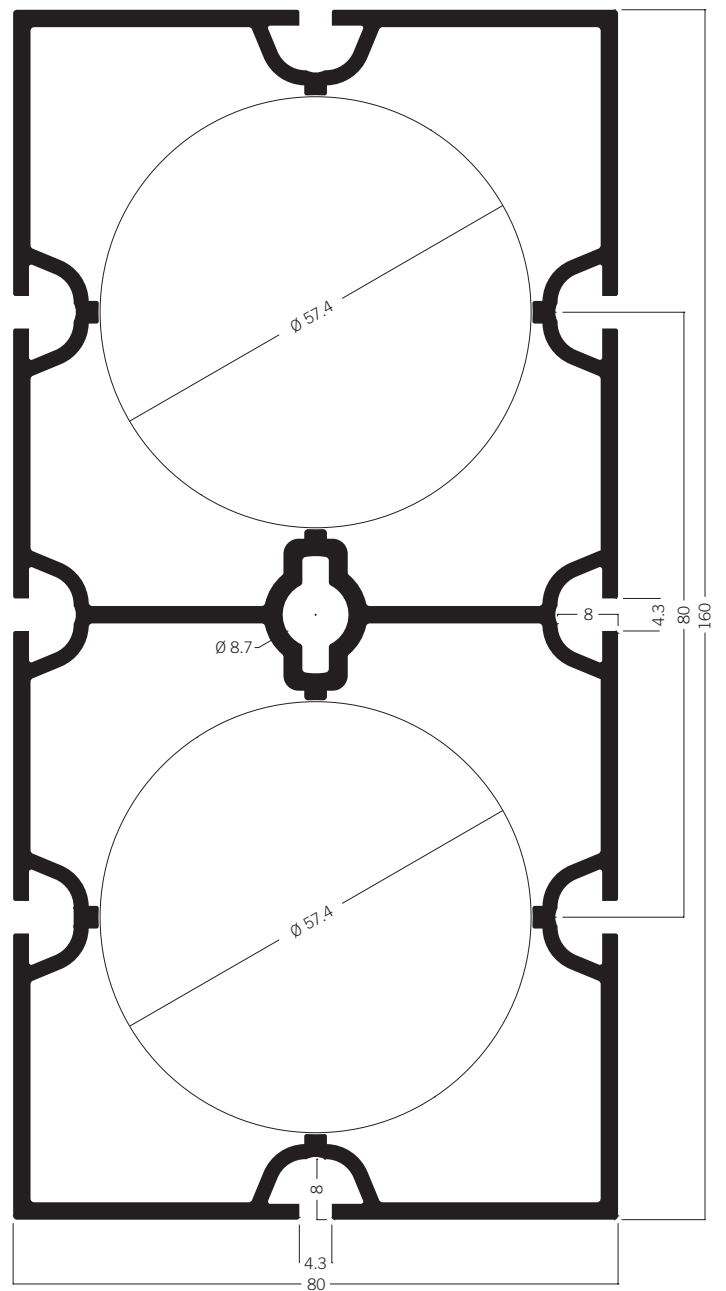

M 1052 * Rectangular extrusion 160 mm
28.35 kg

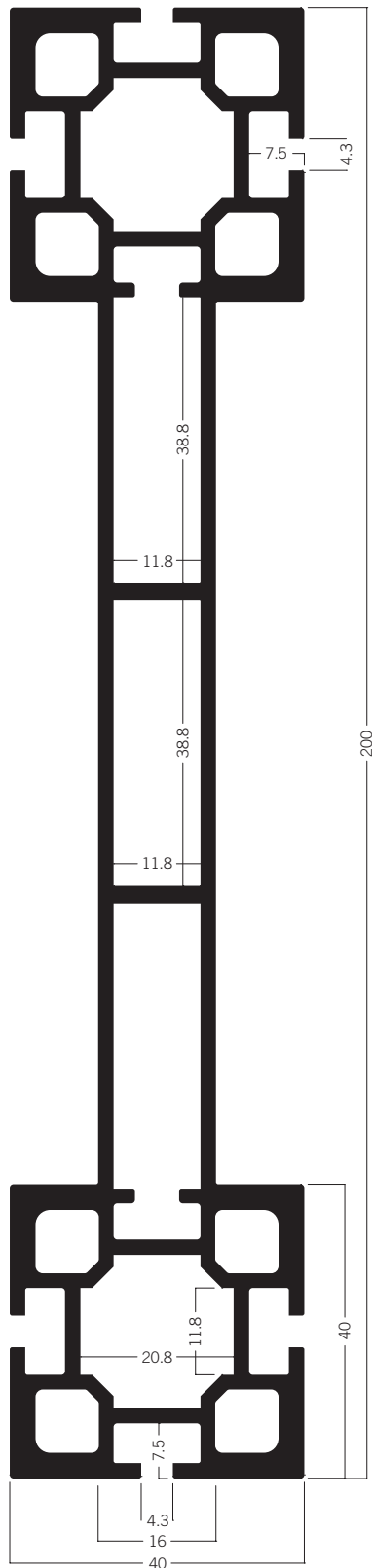

M 770 * Beam extrusion 200 mm
35.53 kg

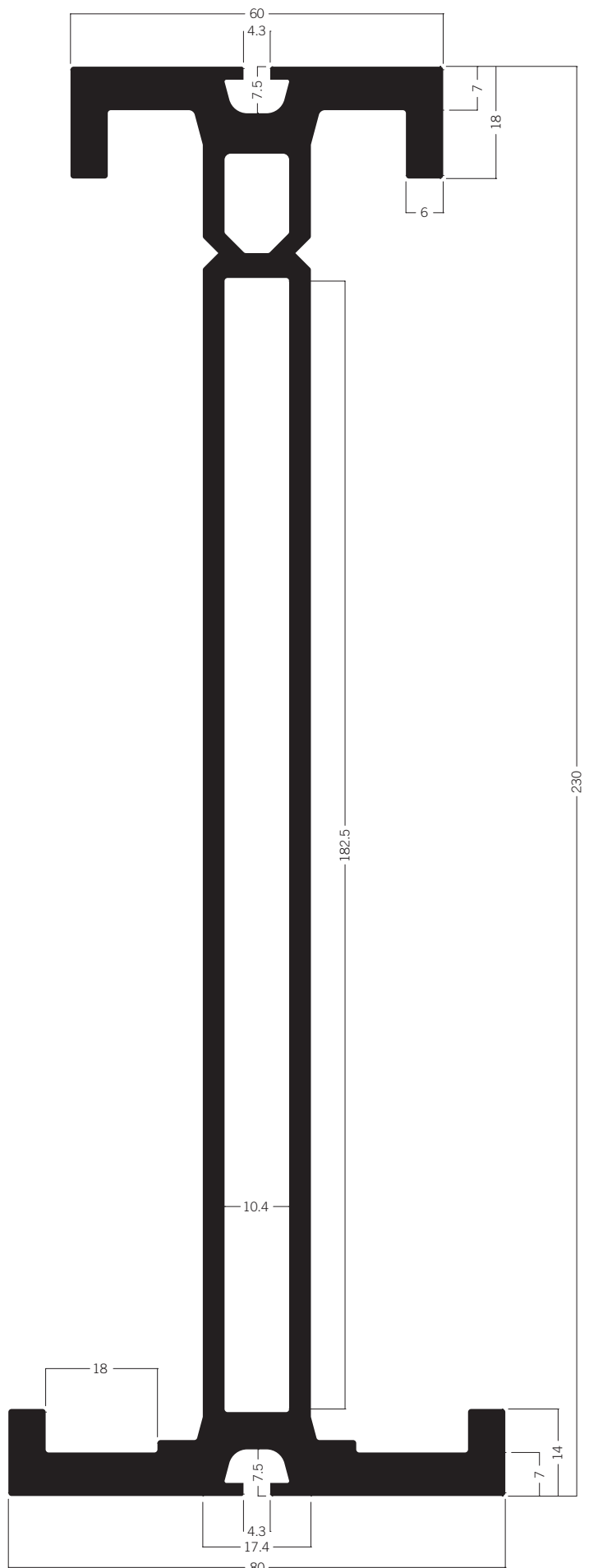

DFL 230 Beam extrusion 230 mm
53.24 kg

ポール・ビーム

Rectangular Extrusions

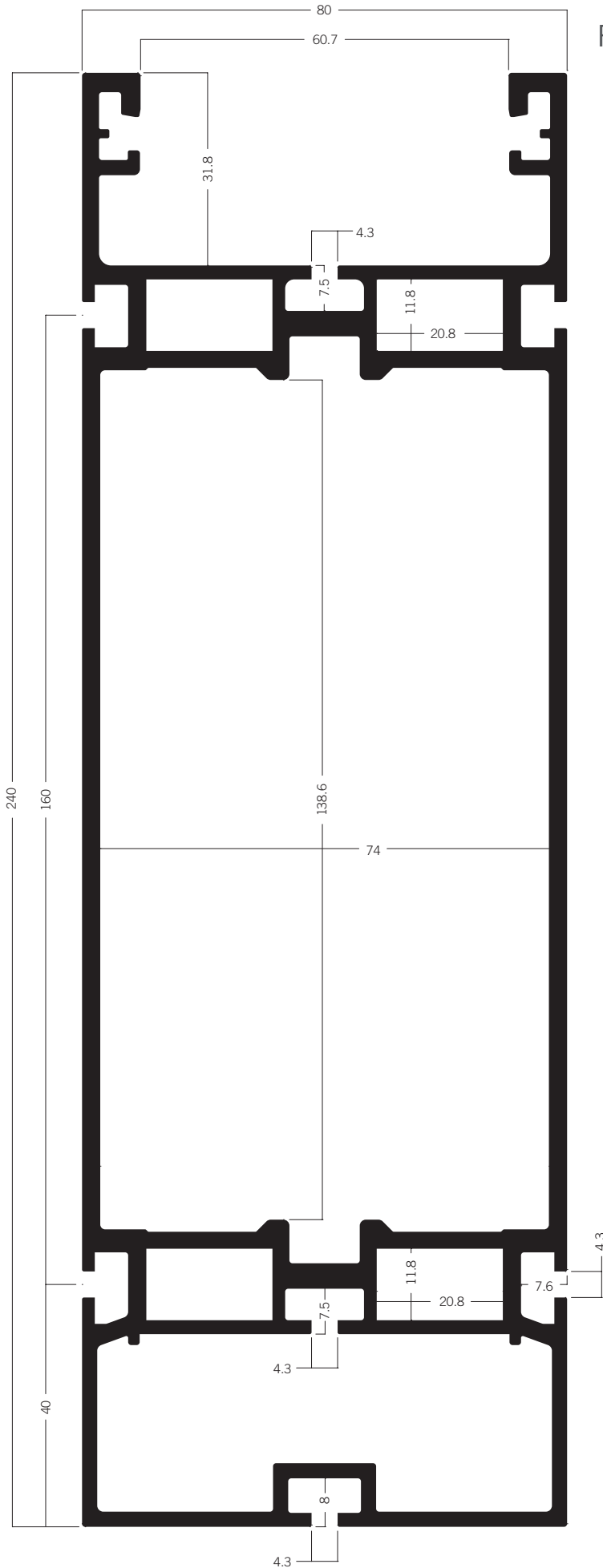

R 102 Rectangular extrusion 240 mm
53.23 kg

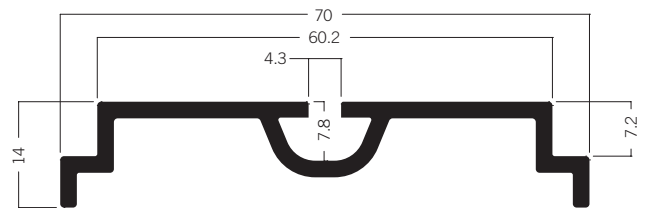

R 122* Cover extrusion 70 mm for R 102
2.88 kg

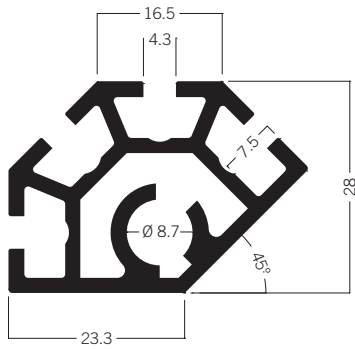

S 203 Upright extrusion 135°
4.87 kg

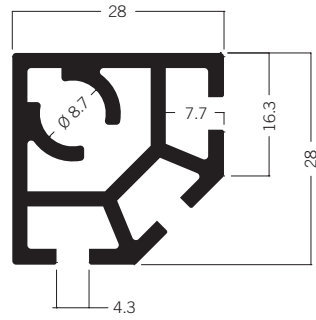

S 308 Upright extrusion 28 mm
4.14 kg

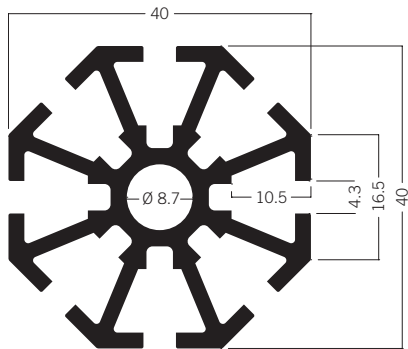

S 100 Upright extrusion 40 mm
6.80 kg

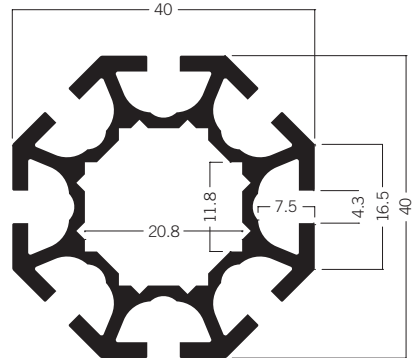

S 108 Upright extrusion 40 mm
5.35 kg

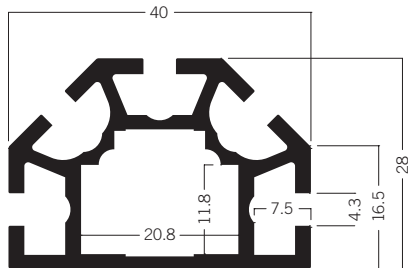

S 201 Upright extrusion 40 mm
4.25 kg

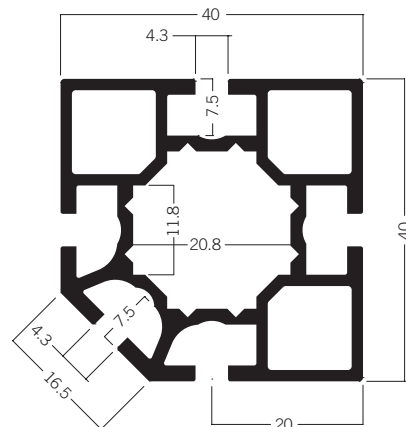

S 380 Upright extrusion 40 mm
5.97 kg

ポール・ビーム

Octagonal Extrusions

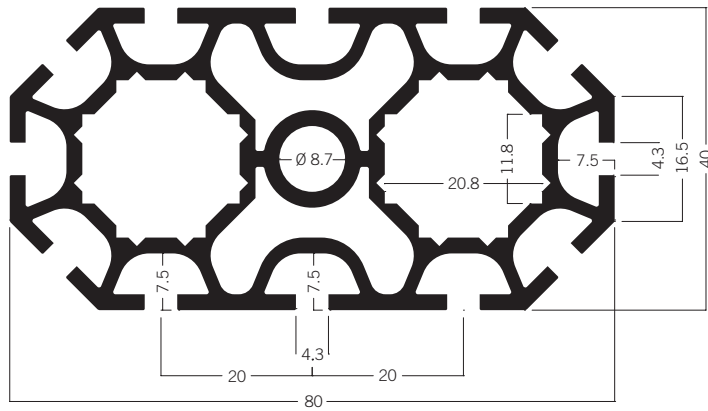

S 408 * Upright extrusion 80 mm
12.64 kg

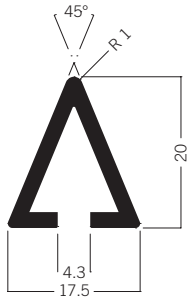

S 206* Interior corner extrusion 45°
1.41 kg

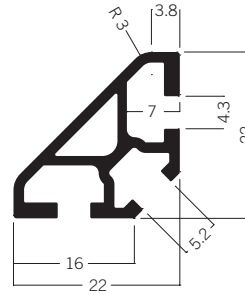

M 1622 * Triangular extrusion 22 mm
1.77 kg

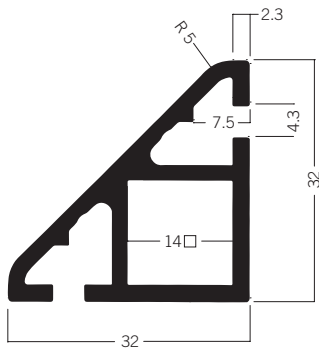

S 1302* Triangular extrusion 32 mm
3.20 kg

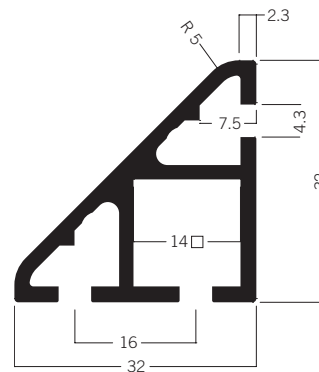

S 1303* Triangular extrusion 32 mm
3.19 kg

ポール・ビーム

Triangular Extrusions

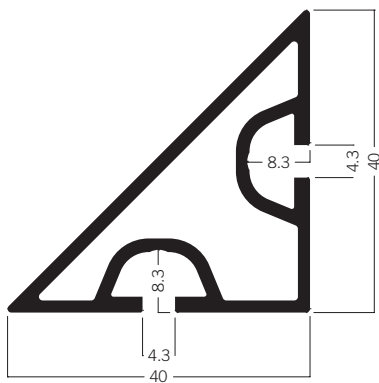

M 1072* Triangular extrusion 40 mm
4.85 kg

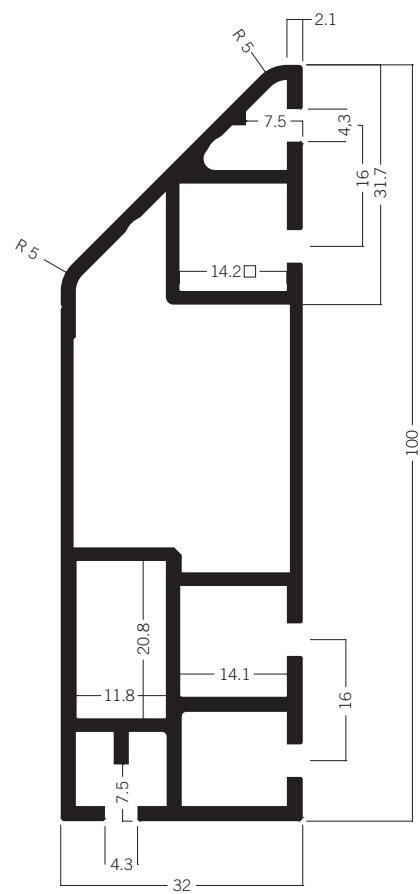

S 1310* Triangular extrusion 100 mm
9.28 kg

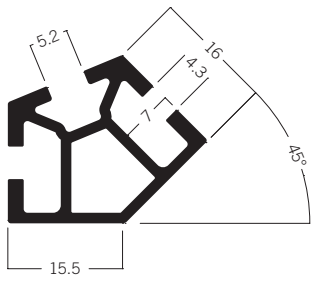

M 1629* Exterior corner extrusion 135°
2.15 kg

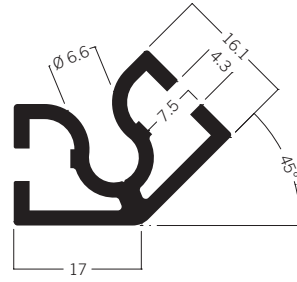

V 2020** Exterior corner extrusion 135°
2.63 kg

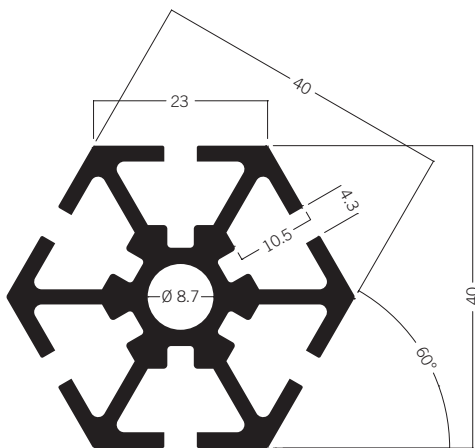

S 500 Upright extrusion 60°
6.98 kg

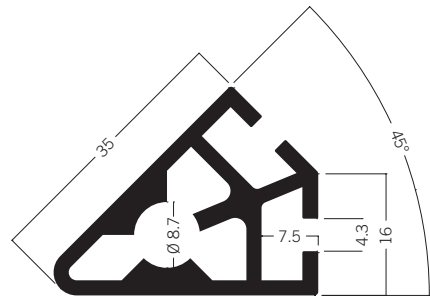

S 302 Upright extrusion 45°
4.03 kg

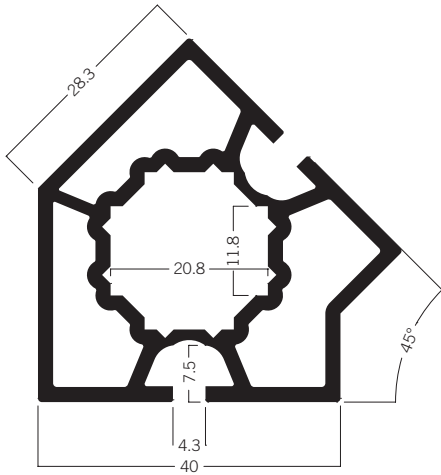

M 1009 Exterior corner extrusion 135°
7.82 kg

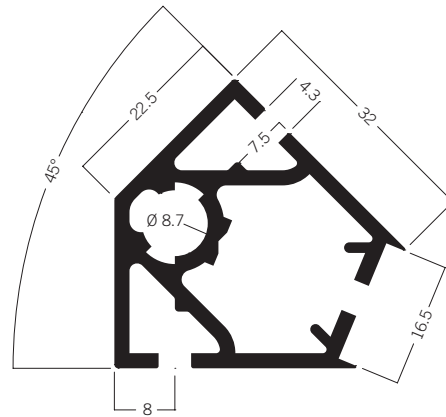

S 1129* Exterior corner extrusion 135°
4.74 kg

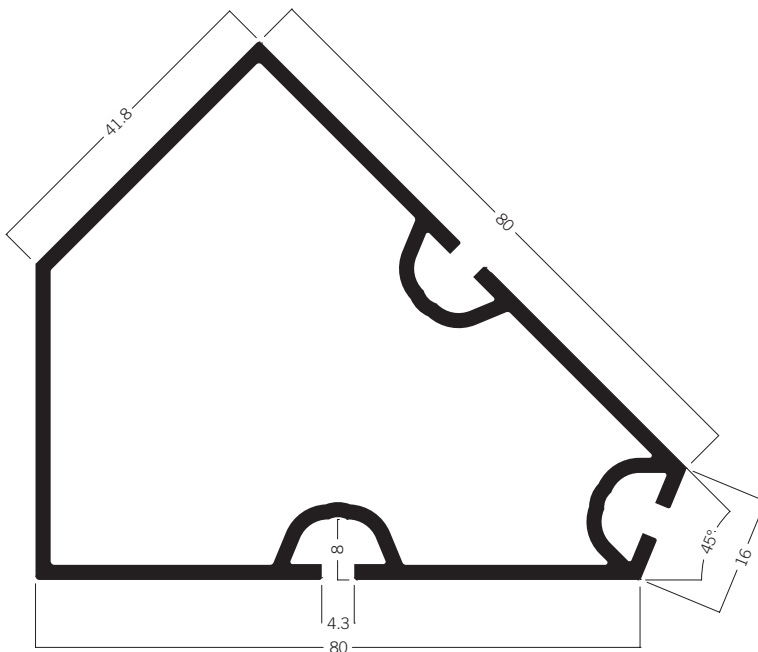

M 1070 Exterior corner extrusion 135°
8.38 kg

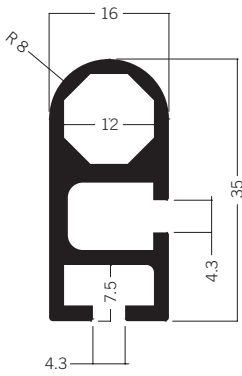

S 250 Hinged extrusion 35 mm
3.14 kg

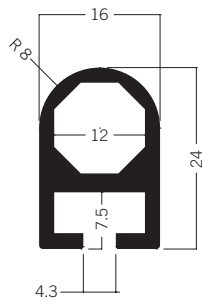

S 251* Hinged extrusion 24 mm
2.24 kg

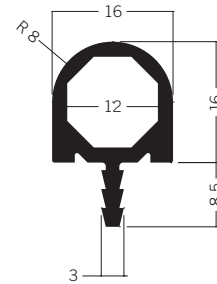

S 252* Hinged extrusion 16 mm
1.73 kg

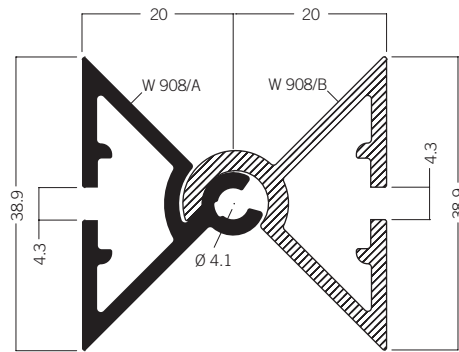

W 908 Hinged extrusion
5.60 kg

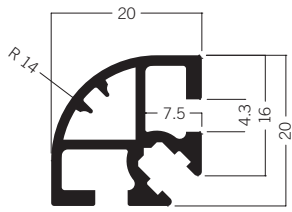

M 1600* Quarter-round extrusion
2.00 kg

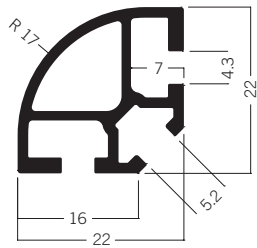

M 1620* Quarter-round extrusion
1.80 kg

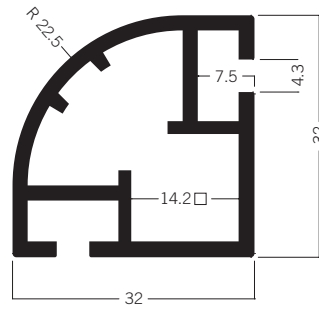

S 1100* Quarter-round extrusion
4.06 kg

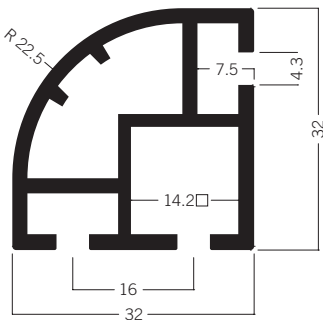

S 1105* Quarter-round extrusion
4.02 kg

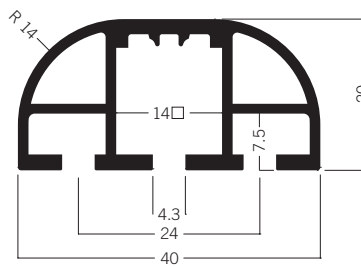

M 1606* Semi-circular extrusion
3.04 kg

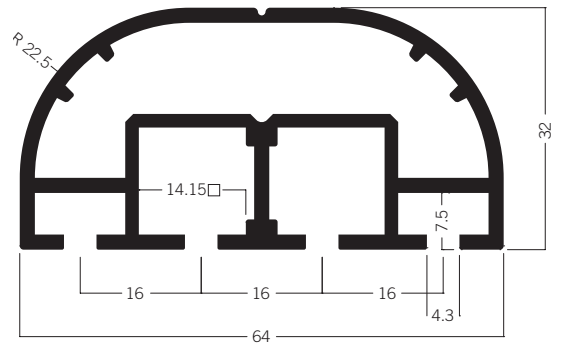

S 1106* Semi-circular extrusion
6.98 kg

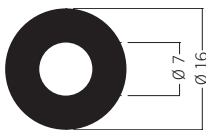

M 1460 Round extrusion 16 mm
2.57 kg

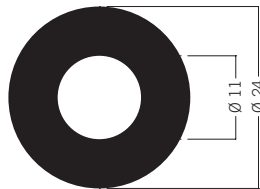

M 1140 Round extrusion 24 mm
4.69 kg

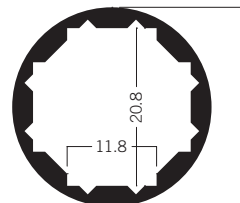

M 1208 Round extrusion 26.3 mm
2.17 kg

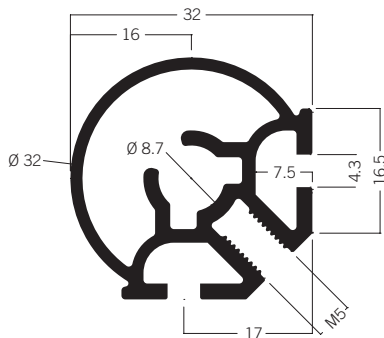

S 1200* Quarter-round extrusion
3.78 kg

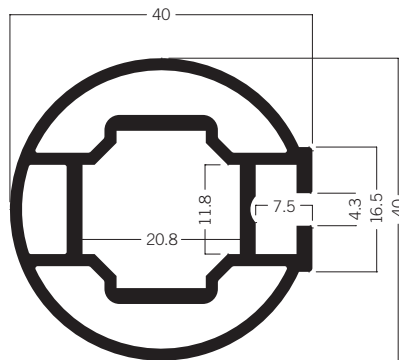

M 1201* Round extrusion 40 mm
5.25 kg

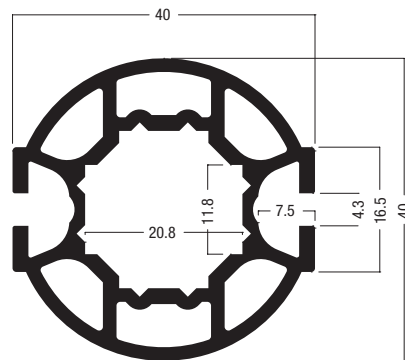

M 1202 Round extrusion 40 mm
6.10 kg

ポール・ビーム

Round Extrusions

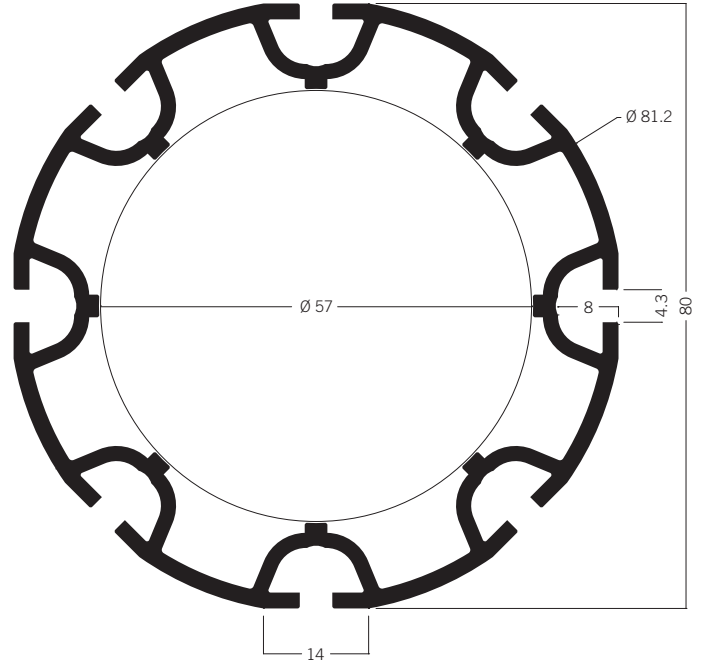

M 1222* Round extrusion 80 mm
10.97 kg

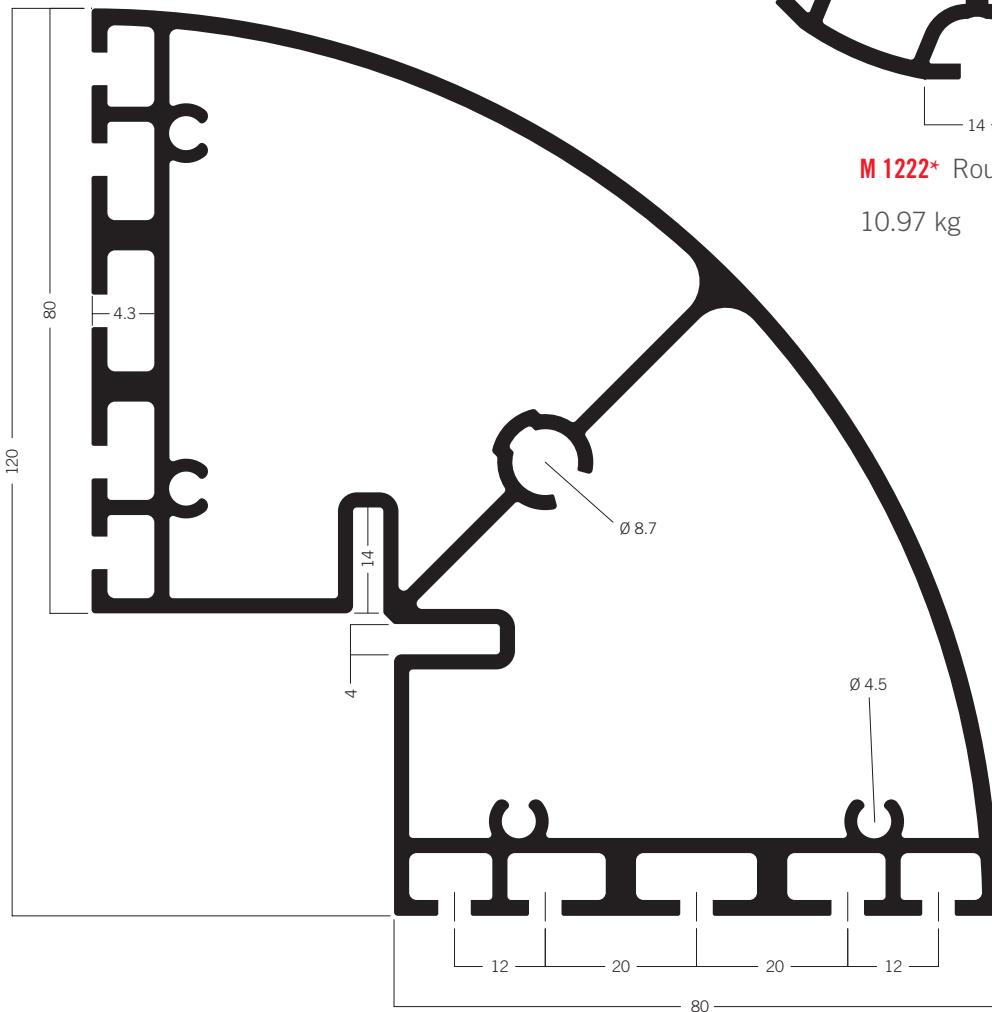

M 260* Upright extrusion 90°
25.50 kg

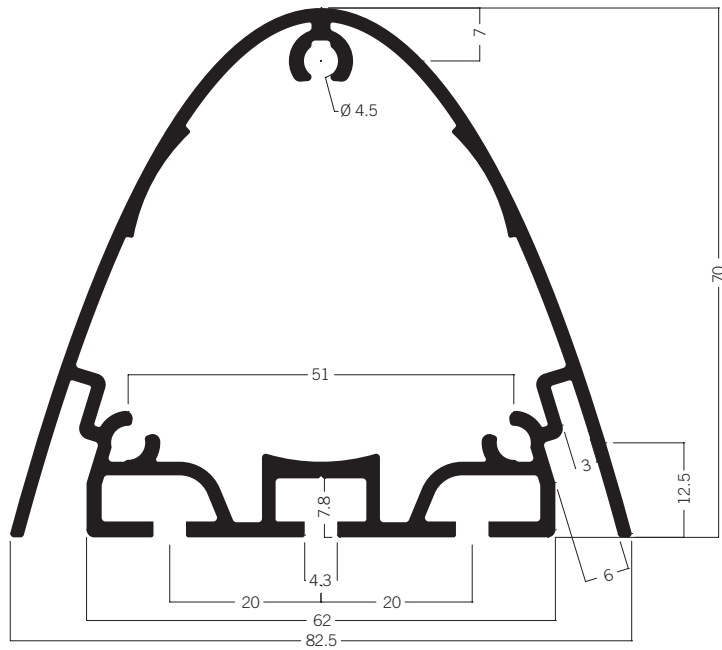

S 3050 * Oval extrusion
11.34 kg

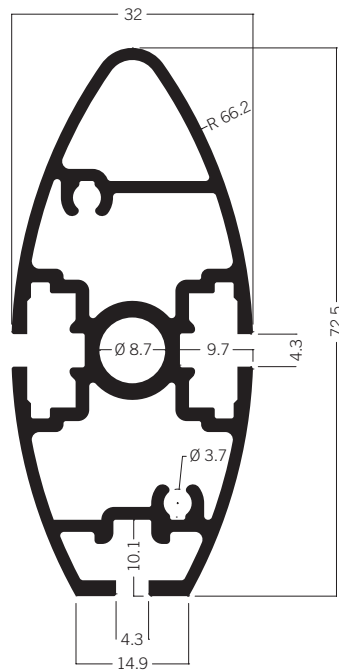

S 6105* Oval extrusion 32 × 72.5 mm
7.65 kg

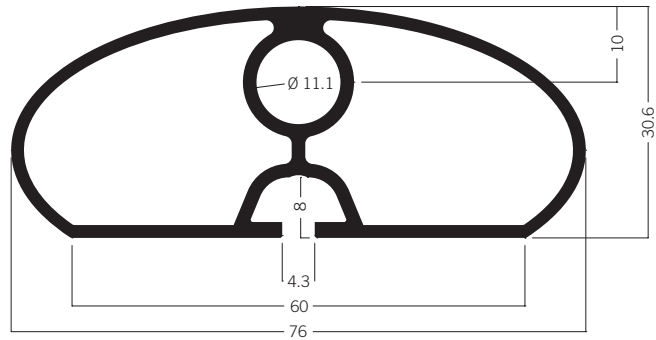

DFL 400 Handrail extrusion
6.96 kg

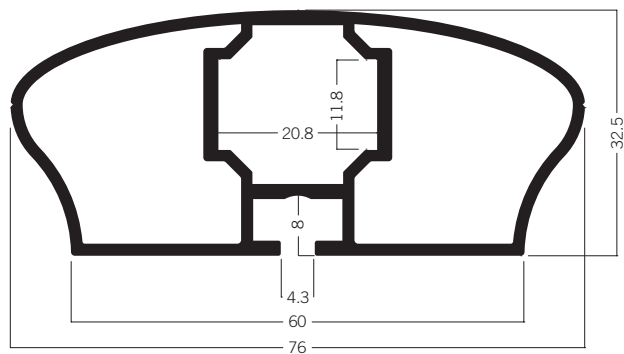

DFL 400A* Handrail extrusion
7.12 kg

FABRIC MOUN TING



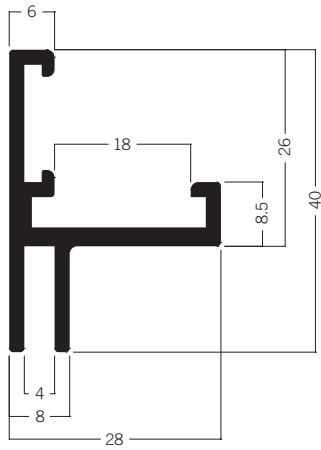

M 1302* Tension fabric extrusion 40 mm
3.49 kg

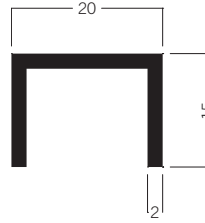

M 1312* U-channel extrusion
1.56 kg

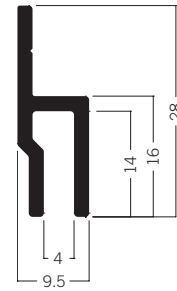

M 1614 Tension fabric extrusion 28 mm
1.54 kg

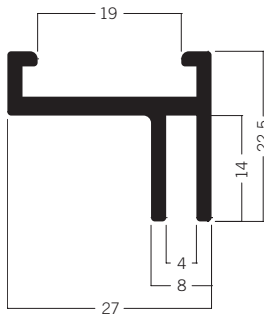

M 1309 Tension fabric extrusion 22.5 mm
2.53 kg

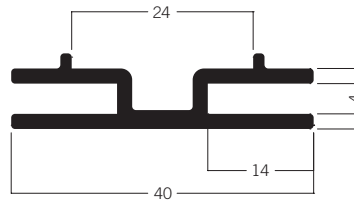

M 1310 Tension fabric extrusion 40 mm
2.69 kg

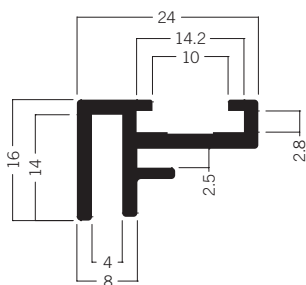

M 1607 Tension fabric extrusion 16 mm
1.91 kg

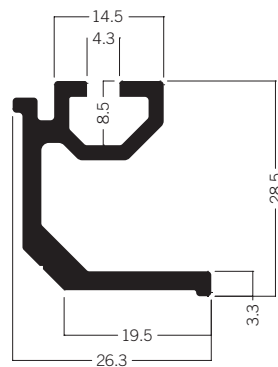

M 1326* Connection extrusion, cube
3.27 kg

ファブリックフレーム

Tension Fabric Extrusions

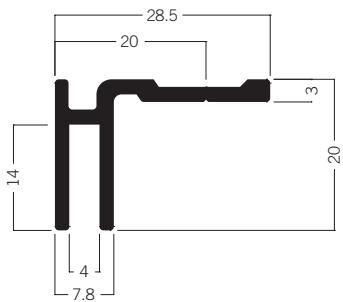

M 1322 Tension fabric extrusion 20 mm
2.03 kg

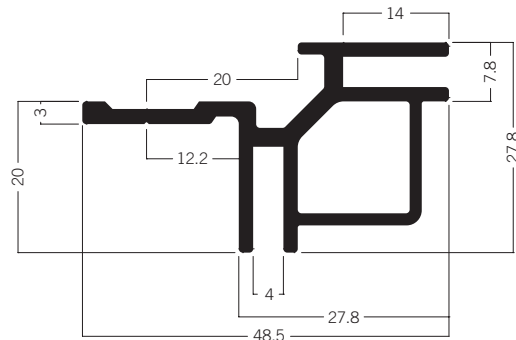

M 1322/E * Tension fabric extrusion, external corner
4.42 kg

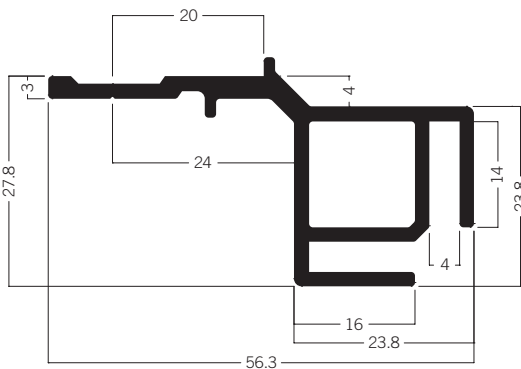

M 1322/I Tension fabric extrusion, internal corner
4.61 kg

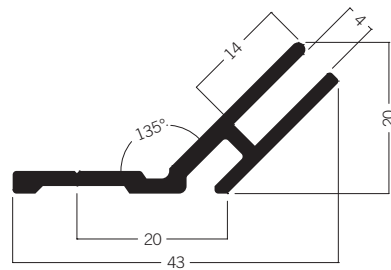

M 1321 Tension fabric extrusion 135°
2.29 kg

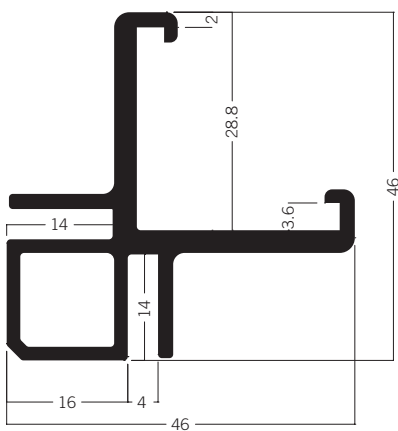

M 1332 Tension fabric extrusion, cube
5.94 kg

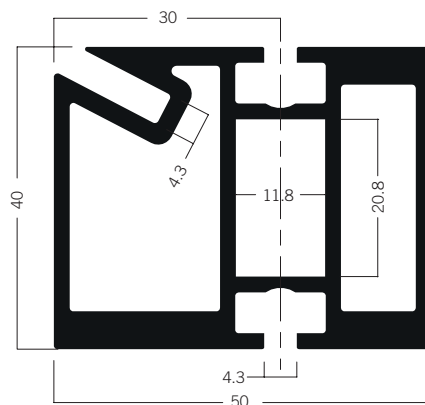

CO 730** Tension fabric extrusion
11.75 kg

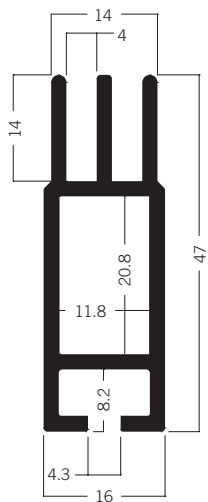

M 1504 Tension fabric extrusion, cube
4.57 kg

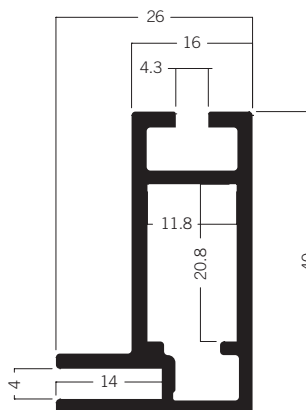

M 1306* Tension fabric extrusion 40 mm
4.55 kg

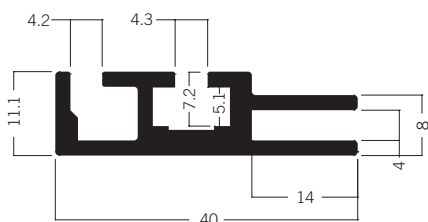

M 1930 Tension fabric extrusion for light frame 40 mm
3.41 kg

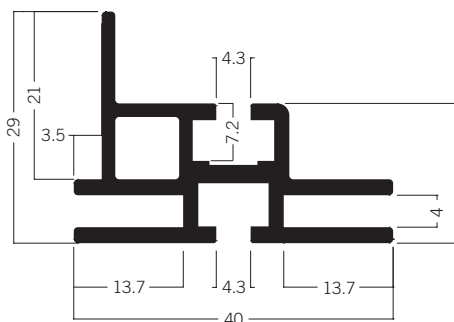

M 1970 Tension fabric extrusion for light frame 40 mm
4.34 kg

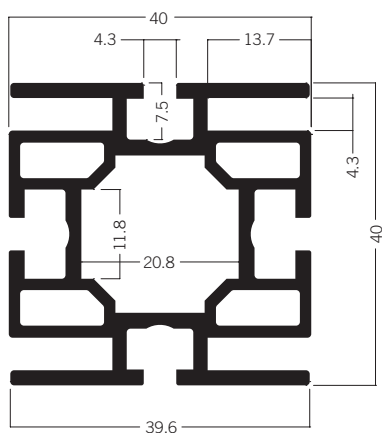

M 1305 Tension fabric extrusion 40 mm
8.23 kg

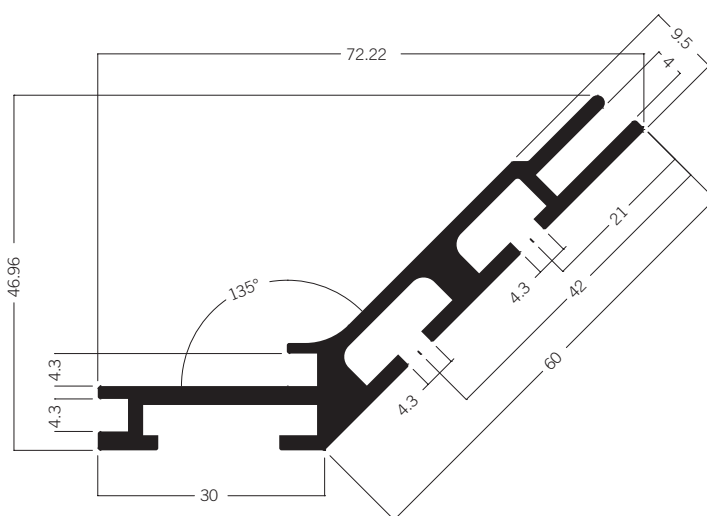

M 1301 Tension fabric extrusion 135°
6.55 kg

ファブリックフレーム

Tension Fabric Extrusions

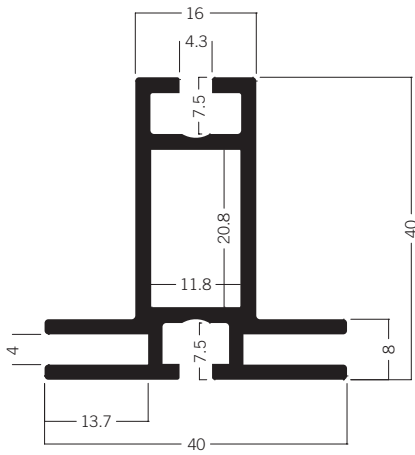

M 1307 Tension fabric extrusion 40 mm

5.39 kg

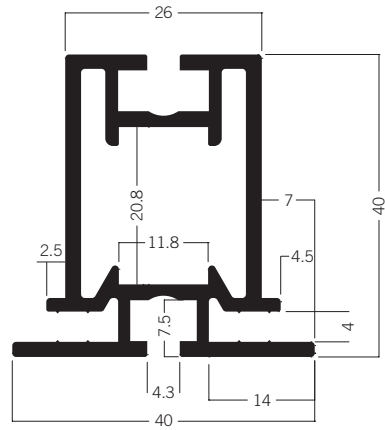

W 906 Tension fabric extrusion 40 mm

6.35 kg

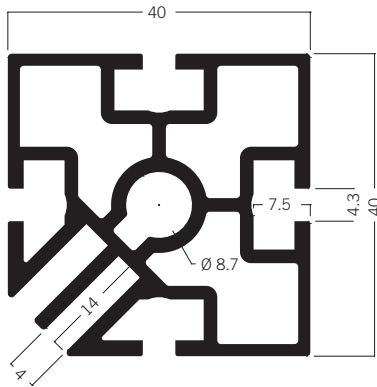

S 382 Upright extrusion 90°,
with silicone edge groove

6.91 kg

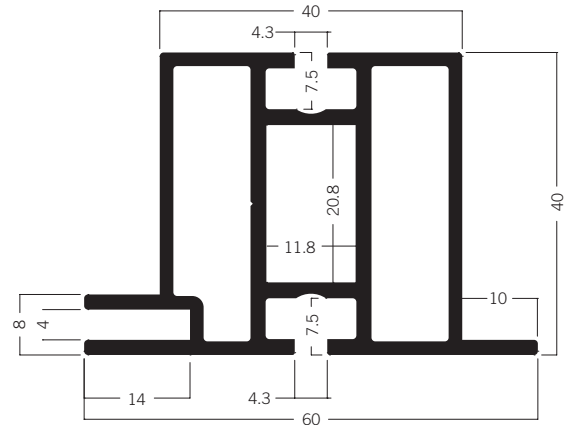

W 730* Tension fabric extrusion 60 mm

8.66 kg

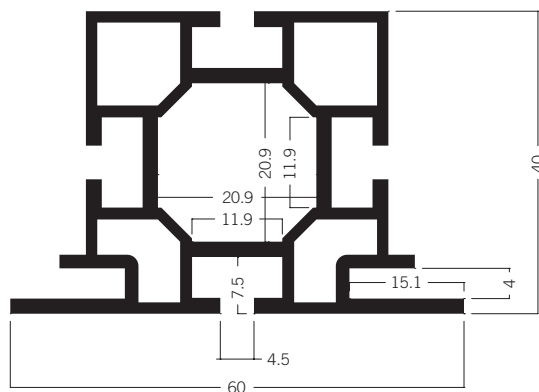

W 735R* Frame extrusion 60 mm universal (USA)

9.20 kg

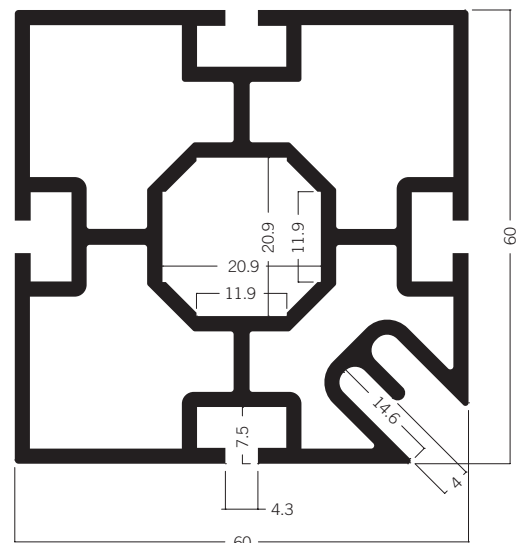

S 385R* upright extrusion,
with silicone edge groove (USA)

14.01 kg

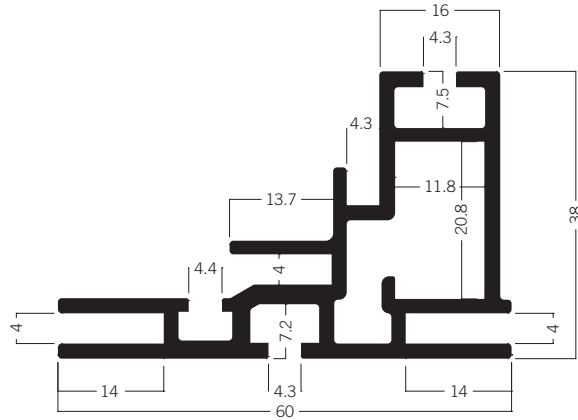

M 1910* Tension fabric extrusion for light frame 60 mm
7.62 kg

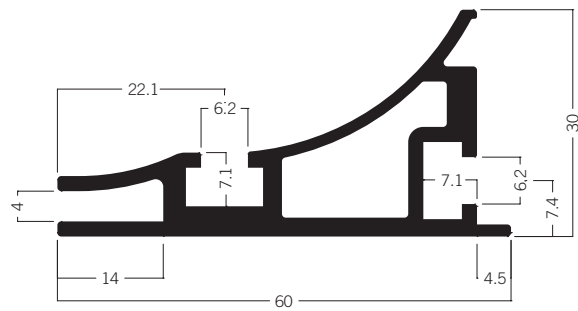

M 1920* Tension fabric extrusion for light frame 60 mm
6.07 kg

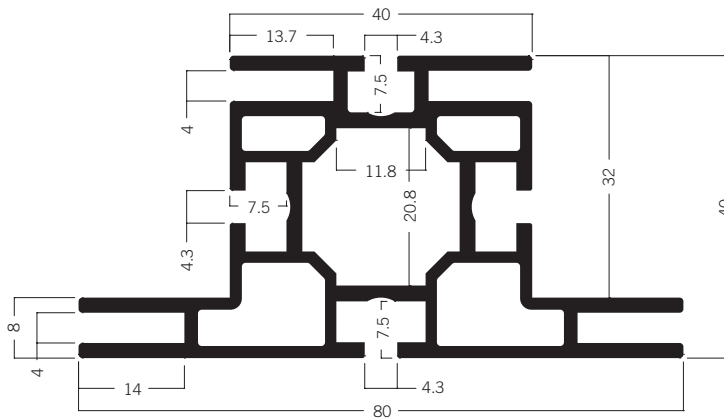

M 1304* Tension fabric extrusion 80 mm
10.15 kg

ファブリックフレーム

Tension Fabric Extrusions

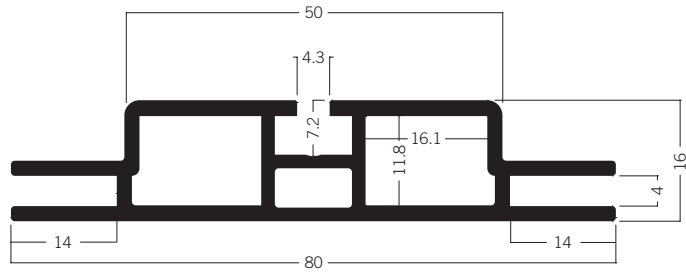

M 1925 Tension fabric extrusion for light frame 80 mm
6.55 kg

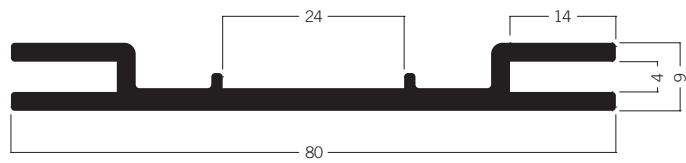

M 1325 Tension fabric extrusion 80 mm
5.33 kg

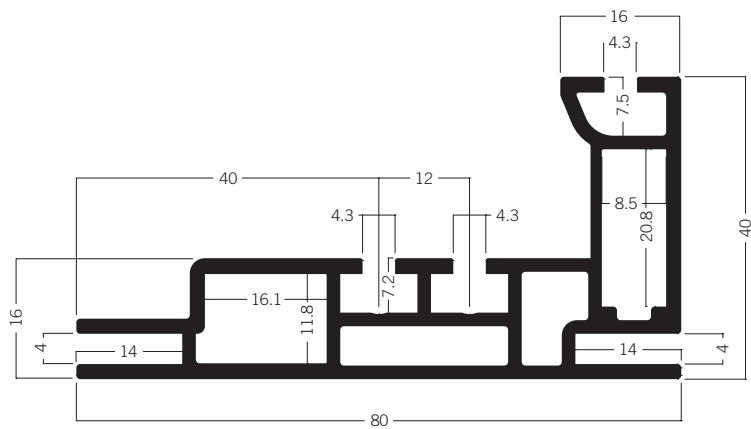

M 1935 Tension fabric extrusion for lightframe 80 mm
9.58 kg

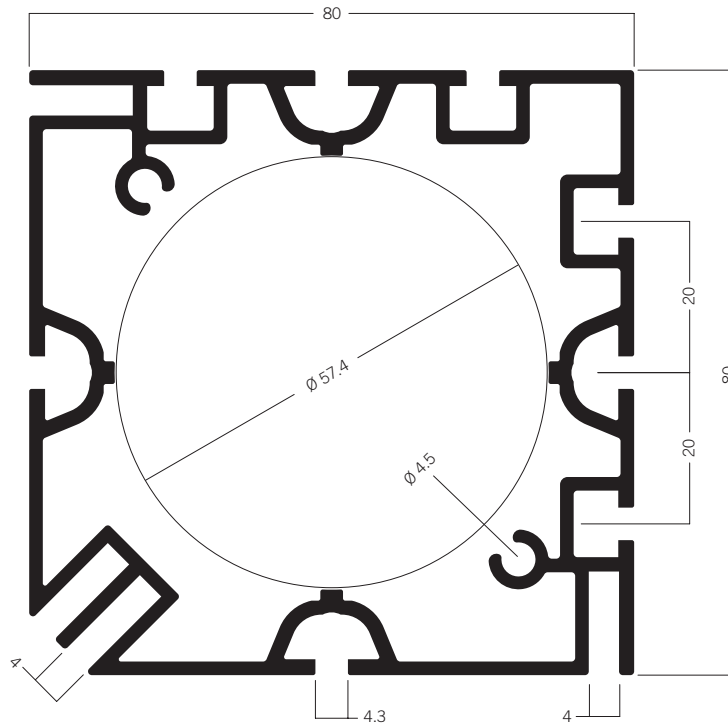

WP 850* Upright extrusion 90°, with silicone edge groove
16.48 kg

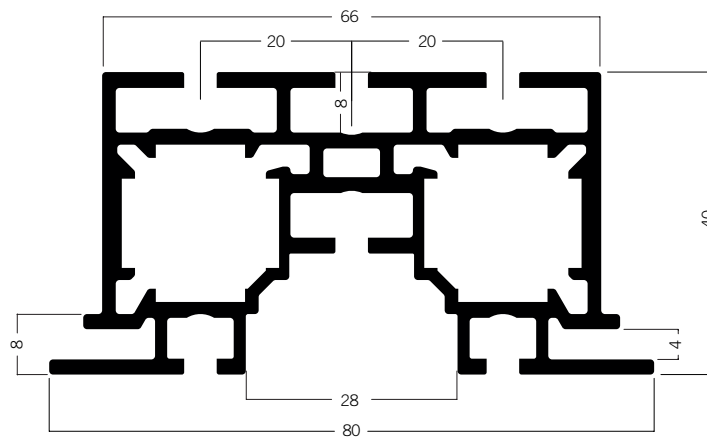

WP 860* Tension fabric extrusion 80 mm
12.99 kg

ファブリックフレーム

Tension Fabric Extrusions

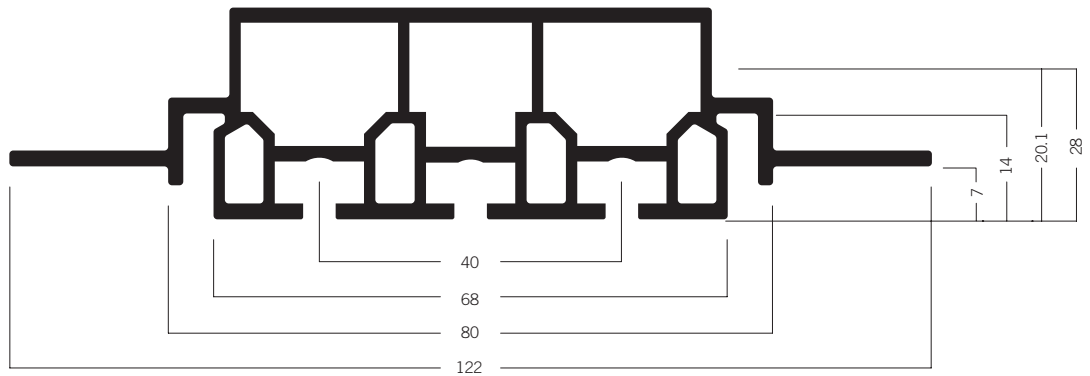

WP 820* T-connection extrusion
11.70 kg

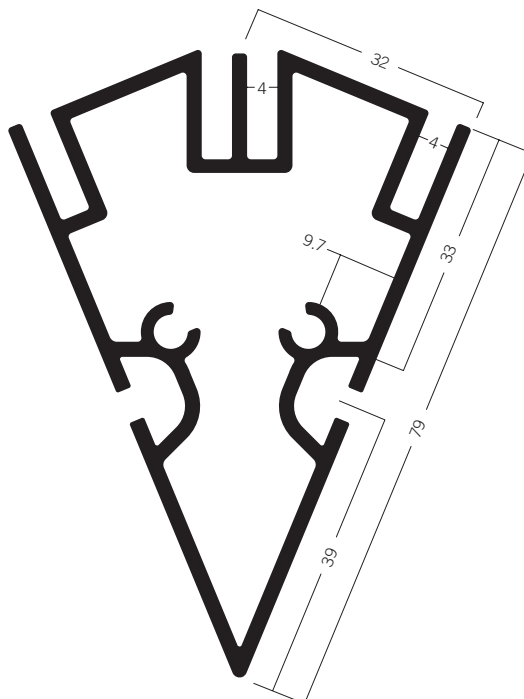

WP 840* Upright extrusion 135°, with silicone edge groove
11.28 kg

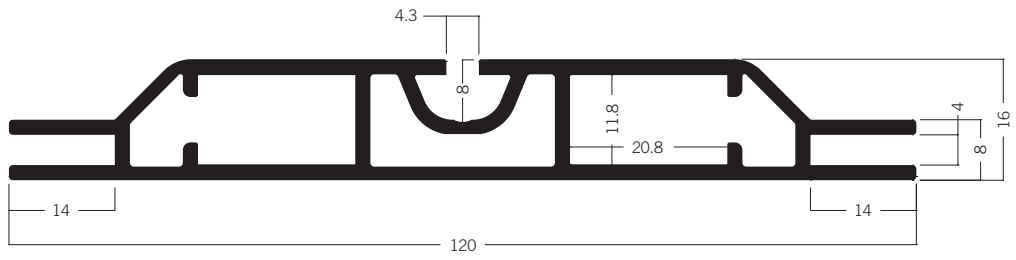

M 1901 Tension fabric extrusion for light frame 120 mm
9.77 kg

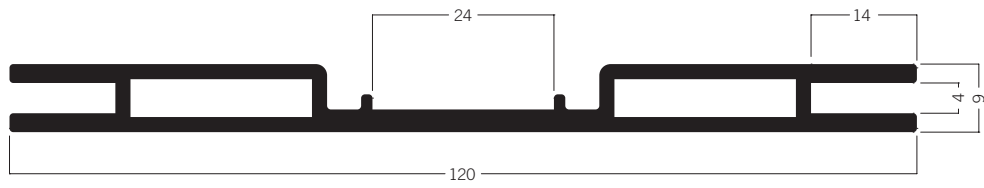

M 1330 Tension fabric extrusion 120 mm
8.28 kg

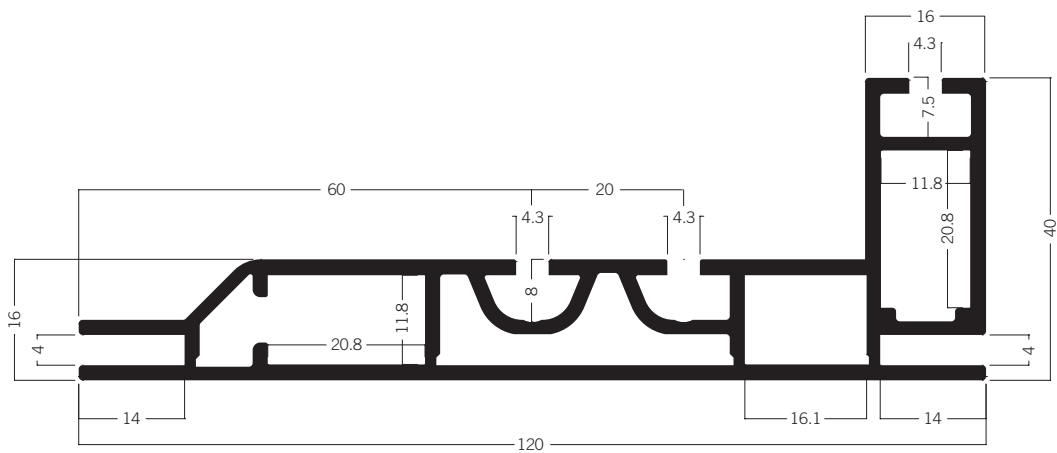

M 1915 Tension fabric extrusion für for light frame 120 mm
11.90 kg

ファブリックフレーム

Tension Fabric Extrusions

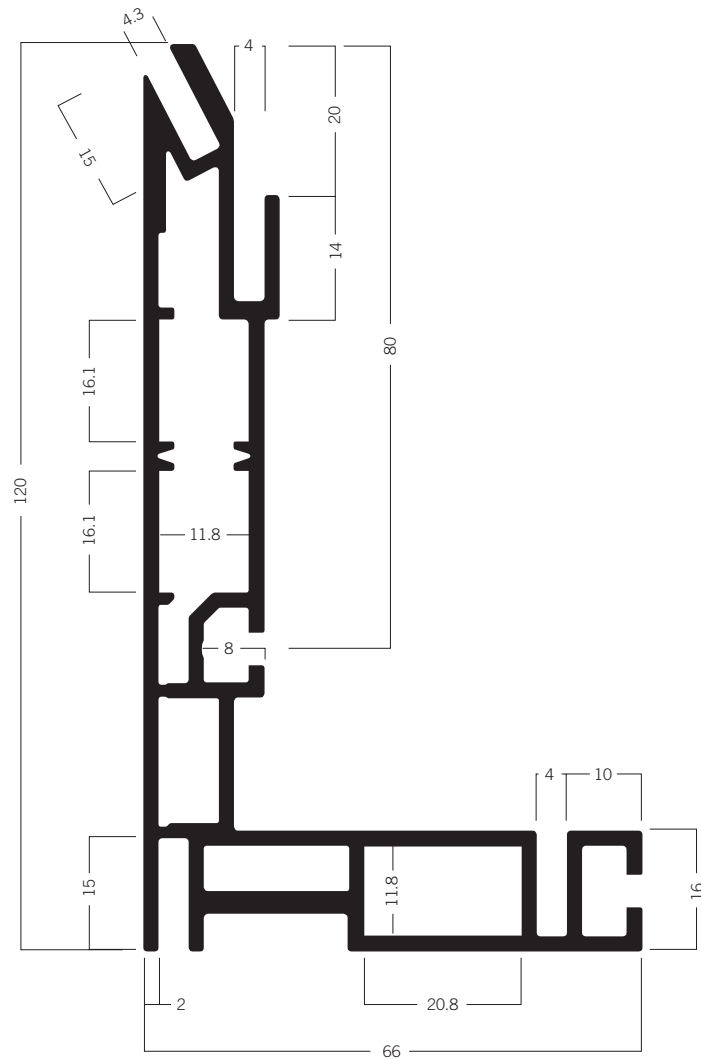

U 1060* Tension fabric extrusion 120 mm
16.20 kg

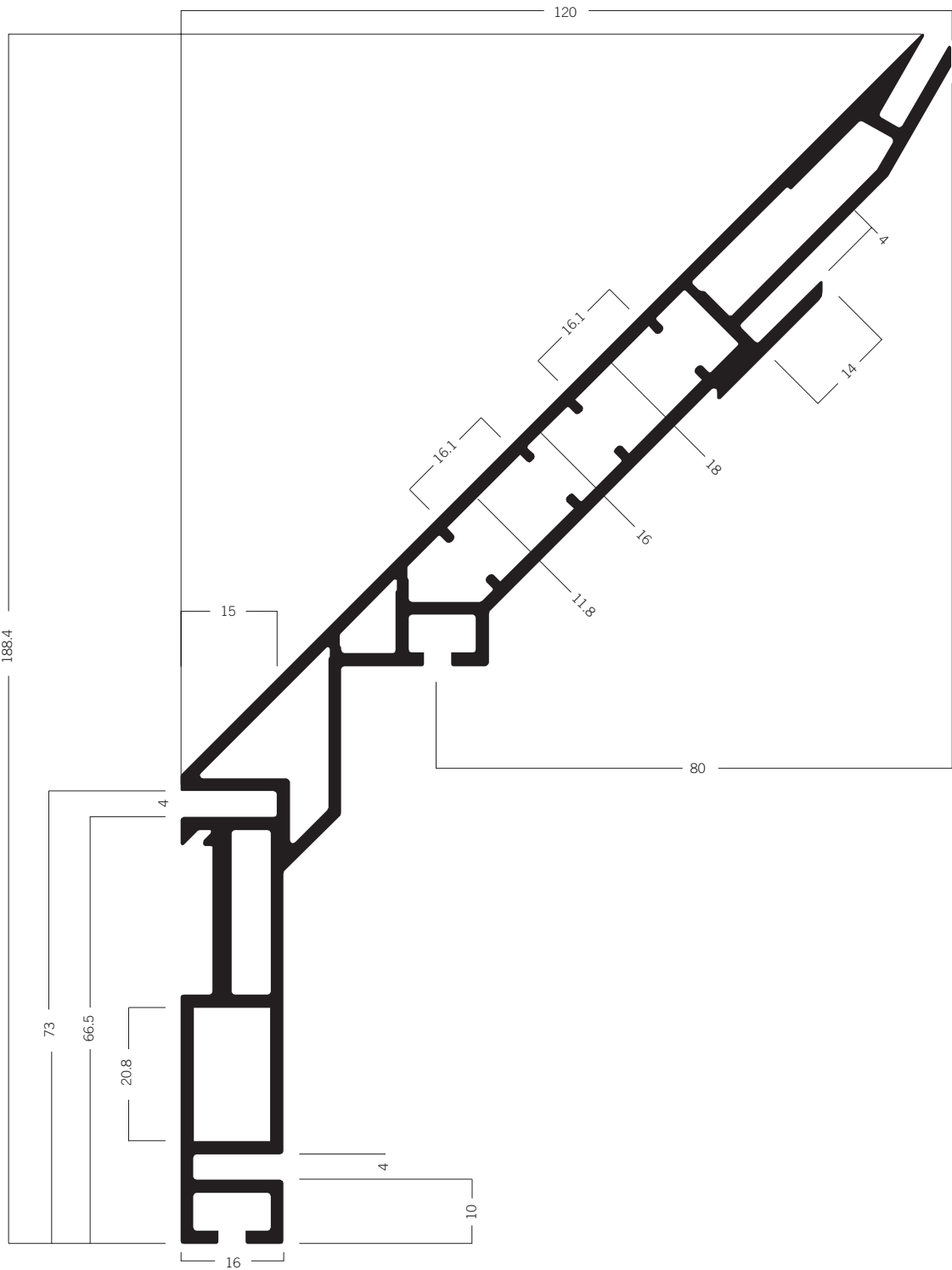

U 1063 * Tension fabric extrusion 120 mm
21.51 kg

ファブリックフレーム

Fabric Suspension Extrusions

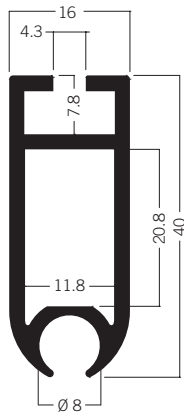

M 1354 Fabric suspension extrusion 40 mm
3.18 kg

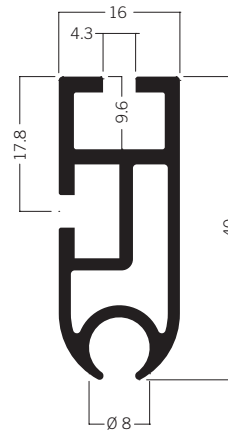

M 1356 Fabric suspension extrusion 40 mm
3.20 kg

**SPECIAL
TYPE
EXTRU
SIONS**





特殊プロフィール

Cover Extrusions

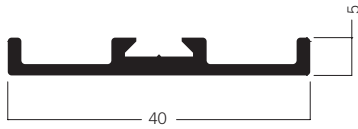

W 910 Cover extrusion 40 mm

1.36 kg

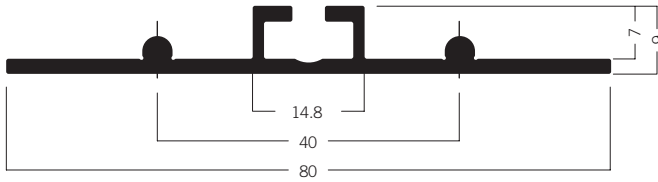

WP 830* Cover extrusion

3.58 kg



M 1367 Cover extrusion

2.12 kg



M 1368 Cover extrusion

3.10 kg

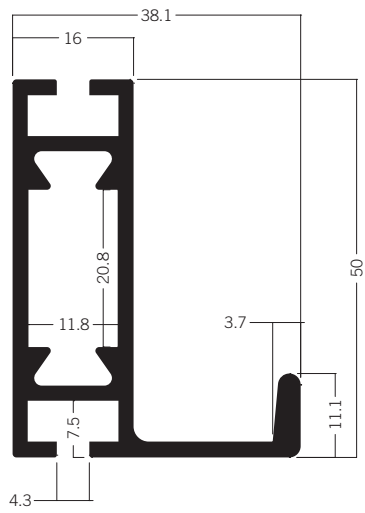

W 101* Beam extrusion 50 mm
5.56 kg

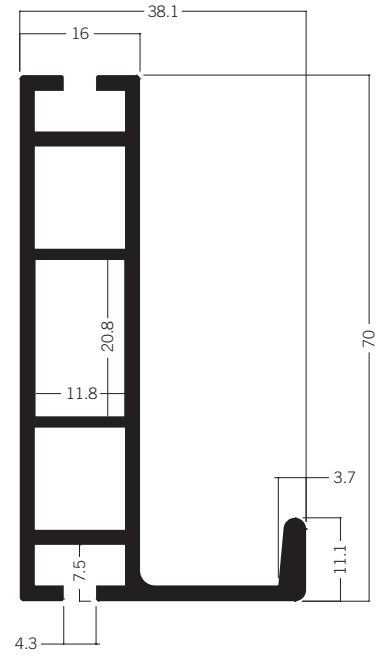

W 103* Beam extrusion 70 mm
6.51 kg

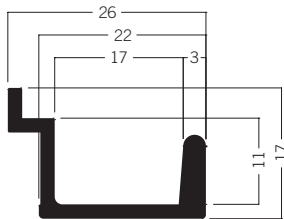

W 110* Adaptor extrusion for cladded wall
1.47 kg

特殊プロフィール

Wall Panel Retainer

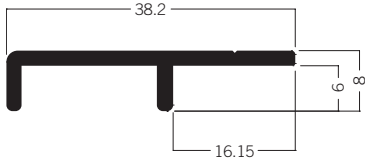

M 1562 Wall panel retainer, top
1.37 kg

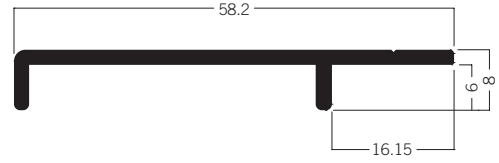

M 1572 Wall panel retainer, top
1.77 kg

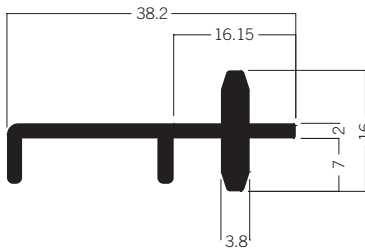

M 1567 Wall panel retainer, center
2.04 kg

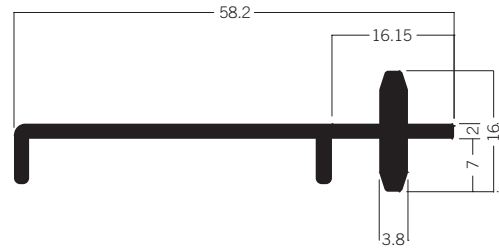

M 1577 Wall panel retainer, center
2.45 kg

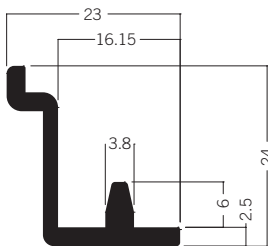

M 1571 Wall panel retainer, bottom
1.62 kg

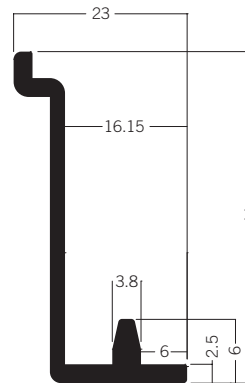

M 1581 Wall panel retainer, bottom
2.02 kg

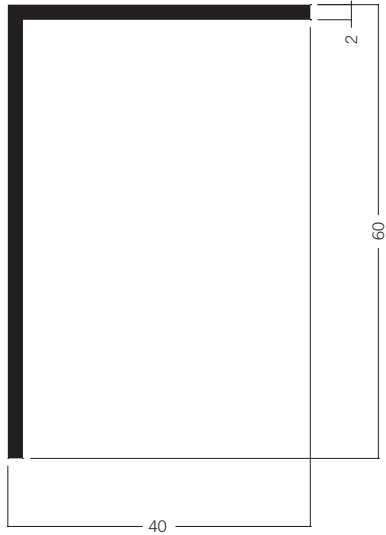

SO 500* Skirting extrusion
2.52 kg

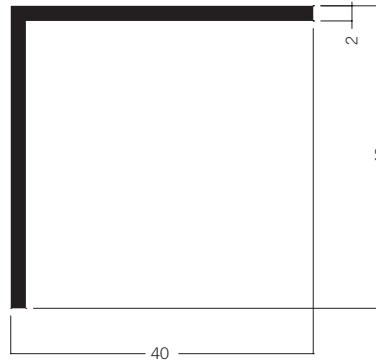

SO 400* Skirting extrusion OCTAeco floor
2.16 kg

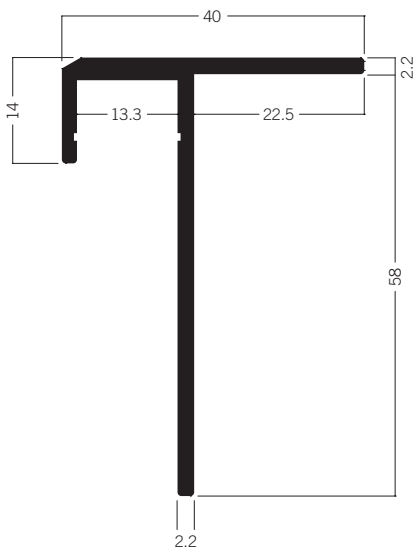

SO 600 Skirting extrusion for LED module
3.31 kg

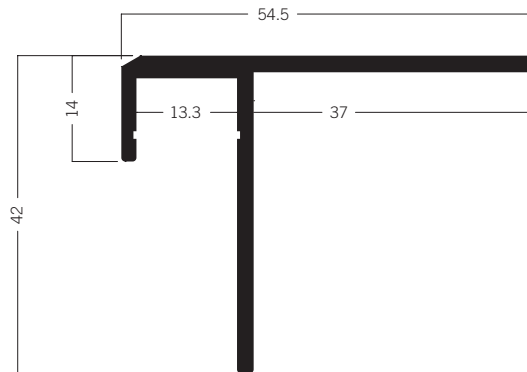

SO 630 Skirting extrusion for LED module
3.20 kg

特殊プロフィール

Skirting Extrusions

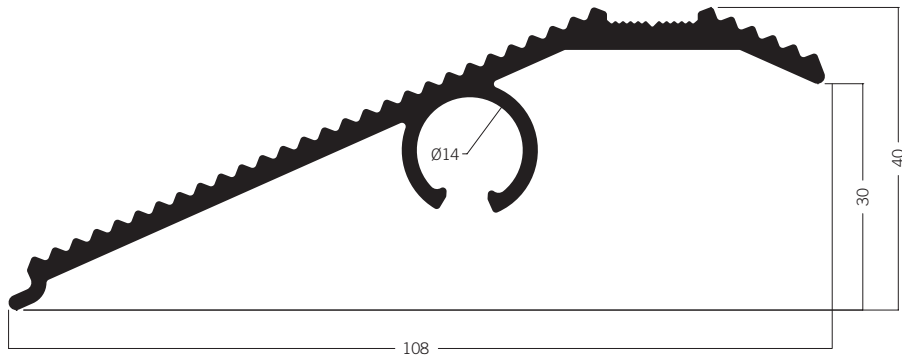

SO 620 Skirting extrusion
6.12 kg

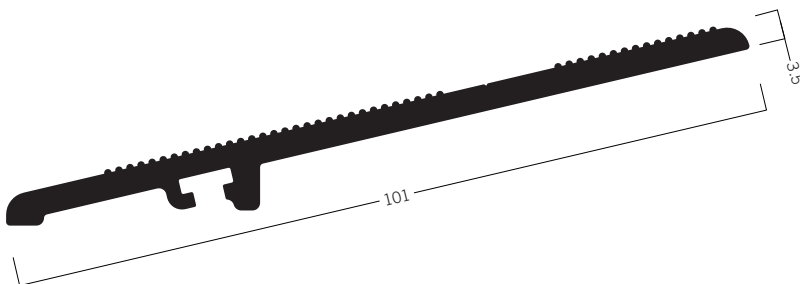

SO 640 Skirting extrusion for slope tile
5.48 kg



SO 642* Laminate skirting for slope corner OCTAeco floor
2.40 kg

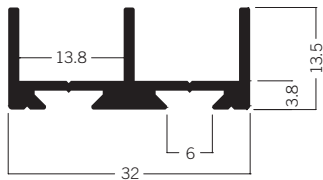

E 470/N* Sliding door extrusion
1.74 kg

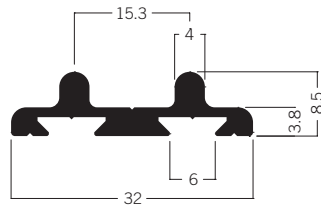

E 471/N* Sliding door extrusion
1.61 kg

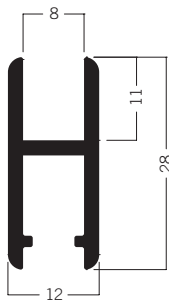

E 472* Runner frame extrusion
1.74 kg

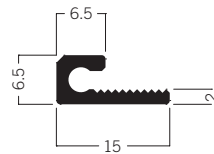

A 200* Edge protection
0.61 kg

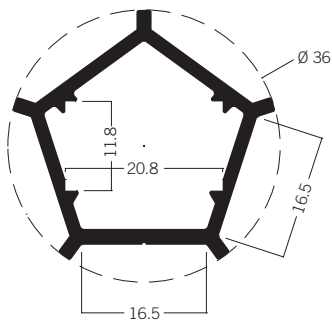

M 1980* Luminous elements extrusion
2.65 kg

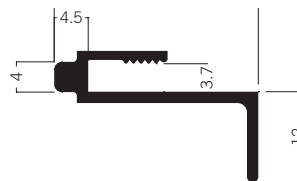

E 410/AL* Door handle extrusion
1.20 kg

特殊プロフィール

Other Extrusions

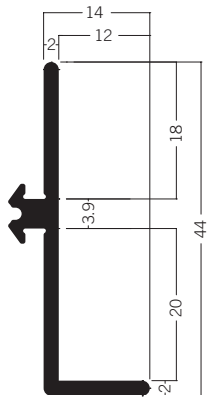

E 850* Insert extrusion
1.86 kg

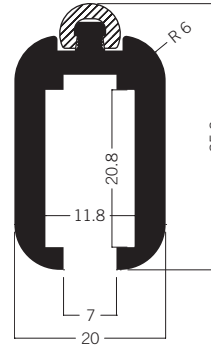

E 800 Wardrobe rail extrusion
4.30 kg

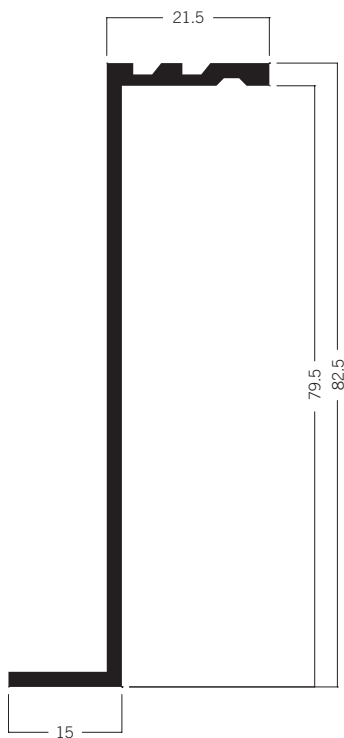

M 1520* Panel retainer extrusion for 80 mm system
3.85 kg



PLASTIC

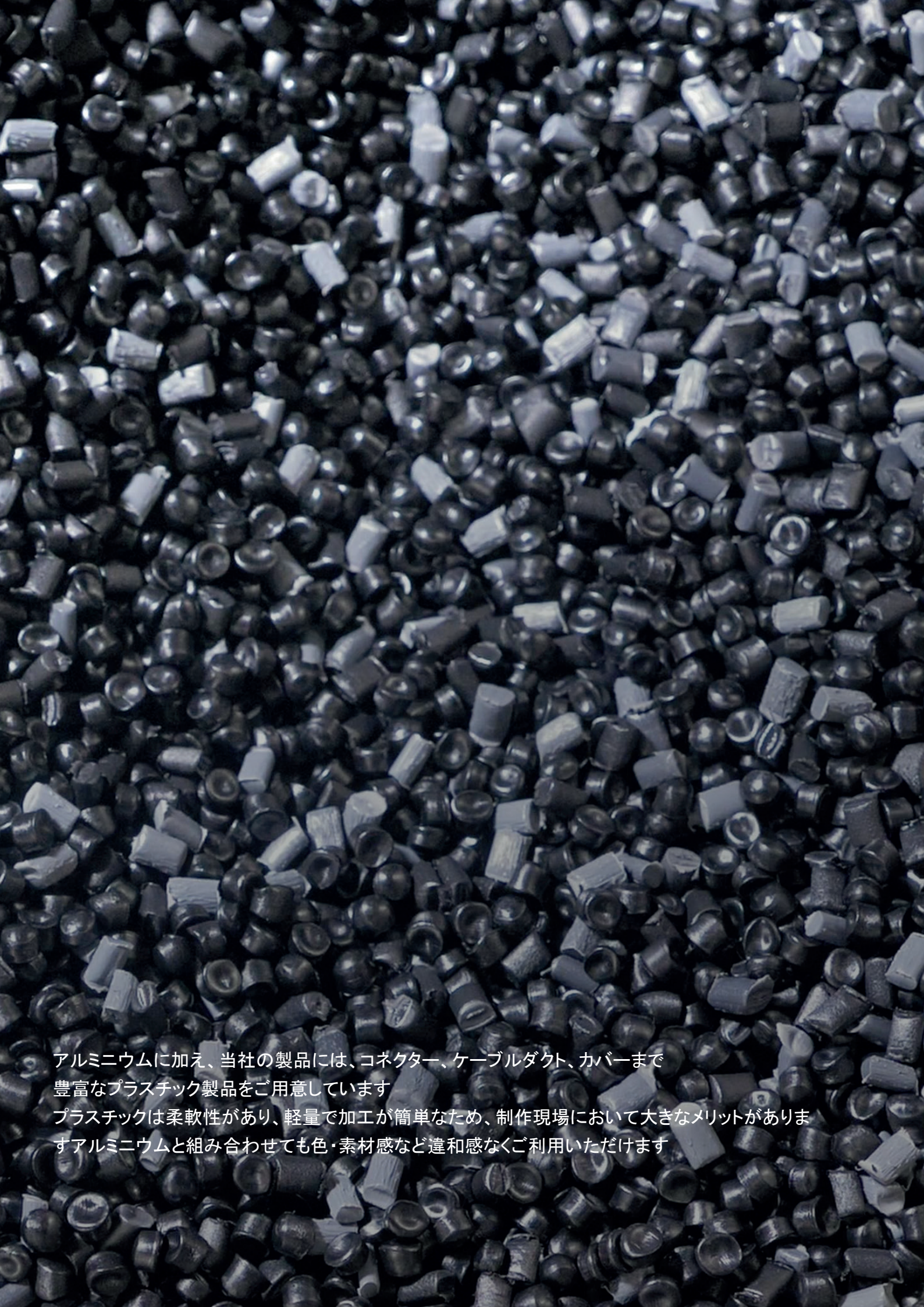

アルミニウムに加え、当社の製品には、コネクタ、ケーブルダクト、カバーまで豊富なプラスチック製品をご用意しています
プラスチックは柔軟性があり、軽量で加工が簡単なため、制作現場において大きなメリットがあります
アルミニウムと組み合わせても色・素材感など違和感なくご利用いただけます



PLASTIC EXTRU SIONS

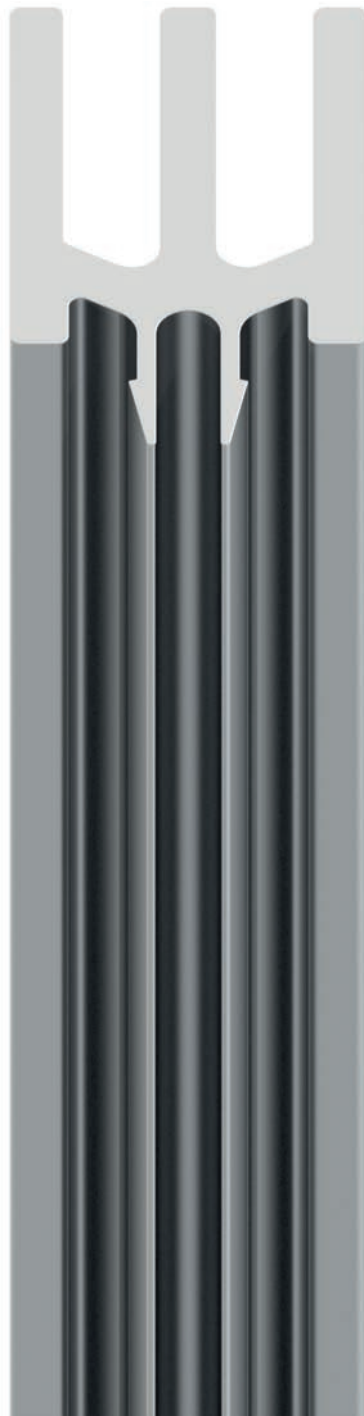

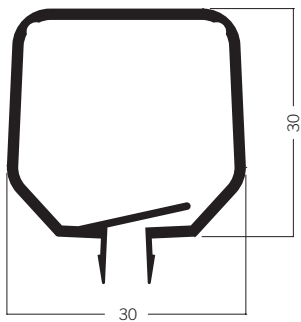

E 463 Cable retaining extrusion
1.20 kg

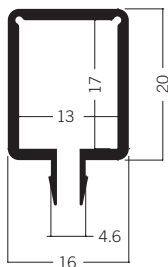

E 460 Cable retaining extrusion
0.73 kg

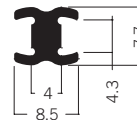

E 438 Extrusion connector
0.28 kg

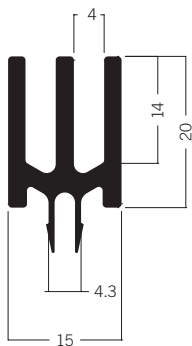

M 1319 Tension fabric extrusion 20 mm
1.46 kg

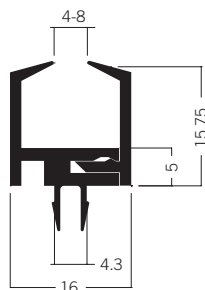

E 420 Glass panel retainer
0.83 kg

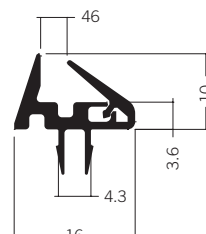

E 424 Glass panel retainer
0.45 kg

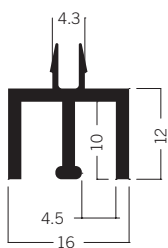

E 400 Upper track for sliding doors
0.60 kg

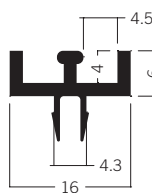

E 401 Lower track for sliding doors
0.45 kg

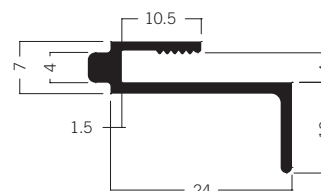

E 410 Door handle extrusion
0.50 kg

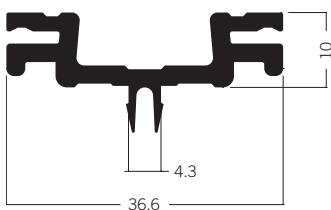

C 160* Adaptor extrusion 10 × 37 mm
1.61 kg

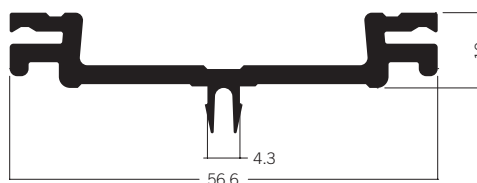

C 159* Adaptor extrusion 10 × 57 mm
2.04 kg

プラスチックプロフィル

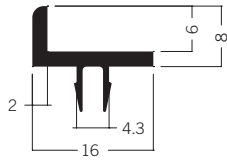

E 442 Supporting edge
0.40 kg

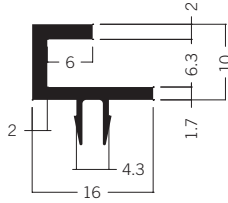

E 440 Glass panel retainer
0.47 kg

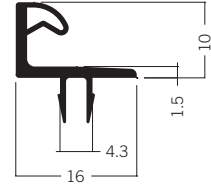

E 430 Door stopping extrusion
0.37 kg

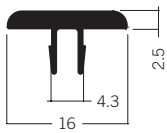

E 458 Cover extrusion
0.38 kg

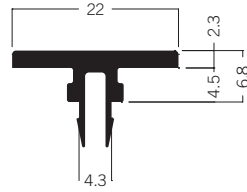

M 1844* Cover extrusion
0.42 kg

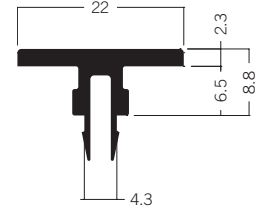

M 1846* Cover extrusion
0.51 kg

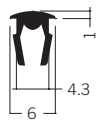

E 455 Groove filler
0.12 kg

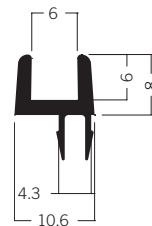

E 421* Glass panel retainer
0.41 kg



E 441 Rubber sponge bumper
1.00 kg

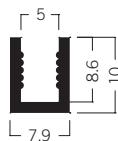

E 476* Clamping extrusion
0.19 kg

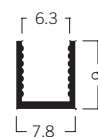

E 477* Clamping extrusion
0.17 kg

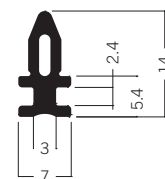

G 725* Extrusion connector
0.26 kg

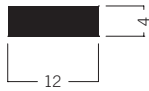

E 480 Flat rubber
0.07 kg

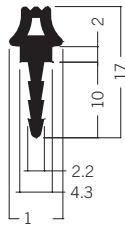

E 451* Extrusion connector
0.35 kg

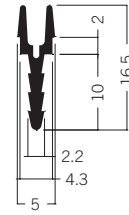

E 452* Extrusion connector
0.23 kg

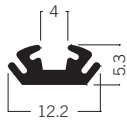

E 444* Anti-rattle strip
2.02 kg

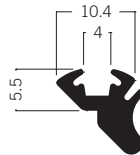

E 445* Anti-rattle strip
3.50 kg

A

A 200 60

C

C 159 66

C 160 66

C 725 67

CO 730 41

D

DFL 230 24

DFL 400 37

DFL 400A 37

DFS 84 11

DFS 84/6000 11

E

E 400 66

E 401 66

E 410 66

E 410/AL 60

E 420 66

E 421 67

E 424 66

E 430 67

E 438 66

E 440 67

E 441 67

E 442 67

E 444 68

E 445 68

E 451 68

E 452 68

E 455 67

E 458 67

E 460 66

E 463 66

E 470/N 60

E 471/N 60

E 472 60

E 476 67

E 477 67

E 480 68

E 800 61

E 850 61

M

M 225 12

M 226 12

M 260 35

M 770 24

M 1000 9

M 1001 9

M 1002 9

M 1003 9

M 1005 9

M 1007 9

M 1009 31

M 1010 9

M 1017 11

M 1018 10

M 1019 10

M 1020 10

M 1021 10

M 1022 10

M 1023 10

M 1025 20

INDEX

M 1026	20	M 1354	51
M 1029	22	M 1356	51
M 1031	22	M 1367	55
M 1041	13	M 1368	55
M 1043	22	M 1400	8
M 1046	13	M 1460	34
M 1052	23	M 1504	42
M 1059	11	M 1520	61
M 1060	23	M 1562	57
M 1063	17	M 1567	57
M 1069	20	M 1571	57
M 1070	31	M 1572	57
M 1072	29	M 1577	57
M 1081	20	M 1581	57
M 1082	20	M 1600	34
M 1092	20	M 1602	14
M 1140	34	M 1603	14
M 1155	11	M 1606	34
M 1201	34	M 1607	40
M 1202	34	M 1614	40
M 1208	34	M 1618	8
M 1222	35	M 1620	34
M 1301	42	M 1622	28
M 1302	40	M 1625	8
M 1304	44	M 1629	30
M 1305	42	M 1844	67
M 1306	42	M 1846	67
M 1307	43	M 1901	48
M 1309	40	M 1910	44
M 1310	40	M 1915	48
M 1312	40	M 1920	44
M 1319	66	M 1925	45
M 1320	17	M 1930	42
M 1321	41	M 1935	45
M 1322	41	M 1970	42
M 1322/E	41	M 1980	60
M 1322/I	41		
M 1325	45	R	
M 1326	40	R 102	25
M 1330	48	R 122	25
M 1332	41		
M 1340	18		

S

S 10	8
S 100	26
S 108	26
S 201	26
S 203	26
S 206	28
S 209	9
S 250	32
S 251	32
S 252	32
S 302	30
S 308	26
S 380	26
S 382	43
S 385R	43
S 408	27
S 500	30
S 1100	34
S 1105	34
S 1106	34
S 1123	8
S 1125	8
S 1129	31
S 1200	34
S 1302	28
S 1303	28
S 1310	29
S 1610	21
S 3050	36
S 6105	36
SO 400	58
SO 500	58
SO 600	58
SO 620	59
SO 630	58
SO 640	59
SO 642	59

U

U 1020	10
U 1030	18
U 1060	49
U 1063	50
U 1066	18

V

V 2000	8
V 2020	30
V 2040	14

W

W 101	56
W 103	56
W 110	56
W 416	14
W 730	43
W 735R	43
W 825	21
W 901	21
W 906	43
W 908	33
W 910	55
WP 820	47
WP 830	55
WP 840	47
WP 850	46
WP 860	46

Z

Z 100	15
Z 110	17
Z 160	17
Z 164	17
Z 300	14
Z 303	14
Z 305	14
Z 307	14
Z 308	14
Z 310	15

Z 400	16
Z 402	16
Z 408	16
Z 460	16
Z 464	16
Z 508	19
Z 560	19
Z 600	19
Z 2100	20
Z 2105	20
Z 4100	15
Z 4300	15
Z 4400	15
Z 4401	15
Z 4700	15



EXHIBITION SYSTEMS
PROJECT SOLUTIONS
PRESENTATION
INTERIOR DESIGN
CLEANROOM SYSTEMS

株式会社オクタノルムジャパン
〒224-0054
神奈川県横浜市都筑区佐江戸町378
TEL. 045 511 8144
FAX. 045 511 8143
info@octanorm.co.jp
www.octanorm.co.jp

EUROPE

OCTANORM® Germany
T. +49 711 77003-0
www.octanorm.com

OCTANORM® Nordic
T. +46 8 621 6500
www.octanorm.se

OCTANORM® Polska
T. +48 22 773 0350
www.octanorm.pl

OCTANORM® Belgium
T. +32 475 35 60 76
www.octanorm.be

OCTANORM® France
T. +33 6 79 11 32 05
www.octanorm.fr

OCTANORM® UK
T. +44 20 85 45 2945
www.octanorm.co.uk

OCTANORM® Espana
T. +34 930 019 424
www.octanorm.es

OCTANORM® Hellas
T. +30 2310 79 6521
www.octanorm.gr

OCTANORM® Italia
T. +39 031 2269715
www.octsystem.it

OCTANORM® Adria
T. +386 590 56301
www.octanormadria.com

AFRICA

OCTANORM® South Africa
T. +27 11 433 2010
www.octanorm.co.za

OCTANORM® Nigeria
T. +234 803 082 1191
www.it-al.design

AMERICA

OCTANORM® North America
T. +1 770 7 32 1520
www.octanormna.com

OCTANORM® México
T. +52 55 5804 6325
www.octanorm.com.mx

ASIA

OCTANORM® China
T. +86 512 6283 3336
www.octanorm.cn

AUSTRALIA

OCTANORM® Australia
T. +61 3 7017 2753
www.octanorm.com.au

MIDDLE EAST

OCTANORM® Emirates
T. +971 4 340 6888
www.octanormemirates.net